

DATED 1ST OCTOBER 2010

(1) JACQUELINE MARGARET THAME AND JOHN GRAHAM REAMS
as Trustees of the will of the late Jessie Thompson

- and -

(2) NORTHAMPTONSHIRE COUNTY COUNCIL

- and -

(3) KETTERING BOROUGH COUNCIL

**PLANNING OBLIGATION BY
WAY OF UNILATERAL
UNDERTAKING**

pursuant to Section 106 of the Town and
Country Planning Act 1990 Land South of
Harrington Road, Rothwell

INSPECTOR REF: APP/L2820/A/10/2129104/NWF

LPA REF: KET/2009/0474

CONTENTS

1.	DEFINITIONS.....	1
2.	CONSTRUCTION OF THIS DEED	5
3.	LEGAL BASIS	5
4.	CONDITIONALITY	5
5.	THE OWNER'S COVENANTS.....	6
6.	RELEASE	6
7.	LAPSE OF UNDERTAKING	6
8.	NOTICES.....	6
9.	CONFLICT BETWEEN THIS UNDERTAKING AND THE STATUTORY POWERS DUTIES AND DISCRETIONS.....	6
10.	REASONABLENESS	7
11.	ALTERNATIVE PLANNING PERMISSIONS.....	7
12.	CONFIRMATION OF DISCHARGE OF PROVISIONS.....	7
13.	PLOT PURCHASERS.....	7
14.	THE CONTRACTS (RIGHTS OF THIRD PARTIES) ACT 1999.....	7
15.	LOCAL LAND CHARGE.....	7
16.	DISPOSALS	7
17.	CONDITIONS	7
	SCHEDULE 1: COVENANTS WITH THE COUNCIL.....	9
	SCHEDULE 2: COVENANTS WITH THE COUNTY COUNCIL	12
	SCHEDULE 3: DESCRIPTION OF THE FOOTWAY/CYCLEWAY WORKS.....	14

ANNEX 1: PLANS

ANNEX 2: TRAVEL PLAN

THIS UNDERTAKING is made on

1st October

2010

BETWEEN:

- (1) **JACQUELINE MARGARET THAME** of Stutchbury Lodge, Sulgrave, Northamptonshire OX17 2HS and **JOHN GRAHAM REAMS** of Frampton Fen, Boston, Lincolnshire PE20 1SJ as trustees of the will of the late Jessie Thompson ("**Owner**");
- (2) **NORTHAMPTONSHIRE COUNTY COUNCIL** of County Hall, Northampton NN1 1DN ("**County Council**");
- (3) **KETTERING BOROUGH COUNCIL** of Municipal Offices, Bowling Green Road, Kettering NN15 7QX ("**Council**").

BACKGROUND:

- A The Council is a local planning authority for the purposes of this Undertaking and section 106 of the Act.
- B The County Council is the highway authority for the area within which the Site is situated.
- C The Owner is the owner of the fee simple absolute in possession of the Site by an Assent made the 25th day of August 1982 and holds the Site as trustees of the will of the late Jessie Thompson and upon trust for sale.
- D The Council has received an application for the grant of planning permission under reference KET/2009/0474 for residential development of the Site ("**Application**").
- E An appeal against the Council's refusal of the Application has been lodged under reference APP/L2820/A/10/2129104/NWF ("**Appeal**") and this undertaking is entered into on the basis that the Secretary of State approves the Appeal.

IT IS AGREED:

1. DEFINITIONS

"**Act**" means the Town and Country Planning Act 1990 (as amended);

"**Affordable Housing**" means subsidised housing that will be allocated in accordance with the Council's then current policies to persons who cannot afford to rent or buy housing generally available on the open market;

"**Affordable Housing Dwellings**" means 30% of the Dwellings to be erected on the Site for the purposes of providing rented and shared ownership accommodation in accordance with the provisions of paragraph 1 of schedule 1 and "**Affordable Housing Dwelling**" shall be construed accordingly;

"**Affordable Housing Land**" means the land on which the Affordable Housing Dwellings are to be situated;

"**Affordable Rent**" means rents within the levels prescribed by the Housing Corporation regulations (or future equivalent) from time to time;

"Allotments Contribution" means a sum of three thousand pounds (£3,000) Index Linked;

"Commencement of Development" means the carrying out of a material operation in respect of the Site as defined by Section 56 of the Act but this shall not include operations in connection with site clearance, ground investigations, demolition of buildings, archaeological investigations, investigations for purposes of assessing environmental contamination, the removal of contamination or the remediation of the Site, diversion and laying of services, the temporary display of site notices or advertisements, or the erection of a site compound or fencing along the boundaries of the Site;

"Conditioned Works" means highway works (if any) conditioned within the Planning Permission to be carried out by the Owner;

"Development" means the development of the Site pursuant to the Planning Permission;

"Dwellings" means the dwelling houses and/or flats erected on the Site in accordance with the Planning Permission (ie the Affordable Housing dwellings and Market Dwellings) and **"Dwelling"** shall be construed accordingly;

"Enhanced Bus Service" means the provision of additional bus services to run on Monday to Saturday evenings and on Sundays and Bank Holidays to enhance the existing bus service number 18 which runs along Harrington Road stopping at existing stops located within walking distance of the Site;

"Enhanced Bus Service Contribution" means the sum of seventy seven thousand pounds (£77,000) per year Index Linked and payable for five (5) years in yearly instalments for the provision of the Enhanced Bus Service;

"Fire and Rescue Contribution" means the sum of eight thousand nine hundred and ninety four pounds (£8,994) Index Linked;

"Footway/Cycleway Works" means the works described in paragraphs 1 to 6 of schedule 3;

"HIST Pooled Contribution" means the sum to be used for HIST Purposes and calculated in accordance with the following formula;

A x B

Where:

A = the maximum number of Dwellings and

B = the sum of three thousand seven hundred and forty one pounds (£3,741).

"HIST Purposes" means:

- (a) the provision of Rothwell Town Centre Improvement Works as determined by the County Council;
- (b) the provision of the highway improvement works exclusive of the Conditioned Works within a five mile radius of Rothwell Town Centre such works to be determined by the County Council;

- (c) Inter-urban and town centre public transport services exclusive of service enhancements referred to in this Undertaking (if any);
- (d) the enhancement of pedestrian and cycle linkages within the Borough of Kettering exclusive to Conditioned Works;
- (e) off site highway improvements required to accommodate traffic arising from the Development exclusive to Conditioned Works and Rothwell Town Centre Improvement Works;
- (f) the provision of a road safety study and subsequent implementation of schemes aimed at enhancing road safety within the Borough of Kettering;
- (g) the provision of a road safety study and subsequent implementation of schemes aimed at enhancing road safety within the Borough of Kettering;
- (h) the provision of intelligent transport solutions where appropriate within the Borough of Kettering;
- (i) the provision of County Council officer resource to facilitate and management HIST Purposes and the consideration associated with reserved matters proposals associated with the Planning permission.

"Index" means the Index for the BCIS all-in tender price published by the Royal Institute of Chartered Surveyors or in the event that the Royal Institution of Chartered Surveyors shall cease to compile or publish the said BCIS all-in tender price Index such other Index as the parties hereto shall agree or in default of agreement such Index as shall be determined for the purposes of this Deed as being an Index which gives an indication of the rate of inflation of such items as are presently comprised in the BCIS all-in tender price Index;

"Index Linked" means in respect of any sum that sum increased or decreased by a percentage equivalent to the percentage increase or decrease shown by the Index between the value of the Index last published at the date of this deed and the value of the index last published at the date of payment of that sum;

"Library Contribution" means the sum of nineteen thousand three hundred and eighty pounds (£19,380) Index Linked;

"Management Entity" means an incorporated or unincorporated body as is agreed between the Owner and the Council;

"Management Entity Protocol" means the framework for the Management Entity setting out its purpose, powers, responsibilities, financial arrangements and internal procedures to be agreed by the Council;

"Market Dwellings" means the dwelling houses and/or flats erected on the Site in accordance with the Planning Permission excluding any Affordable Housing Dwellings and **"Market Dwelling"** shall be construed accordingly;

"Occupation" means occupation for the purposes permitted by the Planning Permission but not including occupation by personnel engaged in construction, fitting out or decoration or occupation for marketing or display or occupation in relation to security operations or for the storage of plant and materials and **"Occupy"** and **"Occupied"** shall be construed accordingly;

"Open Space" means the areas of open space comprising at least 0.75 hectares of land and a 0.5 hectare screen bund within the Site which are to be laid out and maintained as open space and screen bund in accordance with paragraph 2.1 of schedule 1 to this Undertaking;

"Open Space Maintenance Period" means a period of 12 months after the Open Space has been laid out in accordance with the Planning Permission and paragraph 2.1 of schedule 1 to this Undertaking;

"Outdoor Sports Contribution" means the sum of eight thousand pounds (£8,000) Index Linked;

"Planning Permission" means planning permission granted by the Secretary of State pursuant to the Appeal;

"Plan No 1" means the plan marked Plan No 1 at Annex 1 to this Deed;

"Plan No 2" means the plan marked Plan No 2 at Annex 1 to this Deed;

"Play Area" means the areas within the Open Space which are to be laid out and maintained as the local area for play and the local equipped area for play in accordance with paragraphs 3.1 and 3.2 of schedule 1 to this Undertaking;

"Play Area Maintenance Period" means a period of 12 months after the Play Area has been laid out and equipped in accordance with paragraphs 3.1 and 3.2 of schedule 1 to this Undertaking;

"Protected Tenant" means any tenant who:

- (a) has exercised the right to acquire pursuant to the Housing Act 1996 or any statutory provision for the time being in force (or any equivalent contractual right) in respect of a particular Affordable Housing Dwelling;
- (b) has exercised any statutory right to buy (or any equivalent contractual right) in respect of a particular Affordable Housing Dwelling;
- (c) has been granted a shared ownership lease by an RSL (or similar arrangement where a share of the Affordable Housing Dwelling is owned by the tenant and a share is owned by the RSL) in respect of a particular Affordable Housing Dwelling and the tenant has subsequently purchased from the RSL all the remaining shares so that the tenant owns the entire Affordable Housing Dwelling;

"Public Transport Works" means the works described at paragraph 7 of schedule 3;

"Rothwell Community Centre Contribution" means the sum of twenty four thousand pounds (£24,000) Index Linked;

"Rothwell Manor Park Contribution" means the sum of five thousand pounds (£5,000) Index Linked;

"Rothwell Town Centre Improvement Works" means highway works to be identified and undertaken by the County Council within the town of Rothwell including but not exclusively on High Street, Fox Street, Harrington Road, Bridge Street, Kettering Road, Desborough Road and Market Square;

"RSL" means a registered social landlord as defined in part 1 of the Housing Act 1996 who is registered with the Housing Corporation (or its future equivalent) pursuant to section 3 of that Act and has not been removed from the register pursuant to section 4 of that Act and who is nominated by the developer of the Site;

"Shared Ownership Dwellings" means those Affordable Housing Dwellings in which the occupier buys an initial share from an RSL who retains the remainder and may charge a rent with the option for the occupier to buy additional shares through a process of staircasing up to outright ownership;

"Site" means the land comprising 3.83 hectares or thereabouts to the South of Harrington Road, Rothwell as shown for identification purposes only edged red on Plan No 1;

"Social Rented Dwellings" means those Affordable Housing Dwellings which shall be offered for rental only at an Affordable Rent;

"Travel Plan" means a travel plan in substantially the form set out in Annex 2 to this Undertaking.

2. CONSTRUCTION OF THIS DEED

2.1 In this Undertaking:

2.1.1 words importing one gender shall be construed as importing any other gender;

2.1.2 the clause and paragraph headings in the body of this Undertaking and the schedules hereto do not form part of this Undertaking and shall not be taken into account in its construction or interpretation;

2.1.3 references to any party to this Deed shall include the successors in title for that party and to any deriving title through or under that party and in the case of the Council and County Council the successors to their respective statutory functions;

2.1.4 any reference to an Act of parliament shall include any modification, of extension or re-enactment of that Act for the time being in force and shall include all instruments, orders, plans regulations, permissions and directions for the time being made, issued or given under that Act or deriving validity from it.

3. LEGAL BASIS

3.1 This Undertaking is a Deed made pursuant to Section 106 of the Act Section 111 of the Local Government Act 1972 and Section 2 of the Local Government Act 2000.

3.2 The obligations given by the Owner in this Undertaking create planning obligations pursuant to Section 106 of the Act and are enforceable by the Council as local planning authority against the Owner.

4. CONDITIONALITY

4.1 This Undertaking shall not take effect until:

4.1.1 the grant of the Planning Permission; and

4.1.2 implementation of the Planning Permission by the Commencement of Development.

5. THE OWNER'S COVENANTS

5.1 The Owner covenants with the Council that it will observe and perform the obligations contained in schedule 1 to this Undertaking.

5.2 The Owner covenants with the County Council that it will observe and perform the obligations contained in schedules 2 and 3 to this Undertaking.

6. RELEASE

No party shall be liable for any breach of the covenants restrictions or obligations contained in this Undertaking occurring after he has parted with his interest in the Site or any part in respect of which such breach occurs but without prejudice to liability for any subsisting breach of covenant restriction or obligation prior to party with such interest.

7. LAPSE OF UNDERTAKING

That (unless otherwise proposed by the Owner) this Undertaking shall be revoked and be of no further effect if the Planning Permission shall lapse without having been implemented or shall be quashed revoked or shall be modified other than at the request of the Owner.

8. NOTICES

8.1 That any notice or other written communication to be served or given by one party upon or to any other under the terms of this Undertaking shall be deemed to have been validly served or given if delivered by hand or sent by registered or recorded delivery post to the party (and where relevant parties to be copied) upon whom it is to be served or to whom it is to be given as specified in clause 8.2 or as otherwise notified for the purpose by notice in writing.

8.2 The addresses for any notice or other written communication are:

8.2.1 the Council at Municipal Bowling Green Road, Kettering NN15 7QX (marked for the attention of the Borough Solicitor);

8.2.2 the Owner at their respective addresses given at the beginning of this Deed;

8.2.3 the County Council at County Hall, Northampton NN1 1DN (marked for the attention of the Head of Legal Services).

8.3 Any notice or other written communication to be given by the Council or the County Council shall be deemed valid and effectual if on its face it is signed on behalf of the Council or the County Council as the case may be or by an officer or duly authorised signatory.

9. CONFLICT BETWEEN THIS UNDERTAKING AND THE STATUTORY POWERS DUTIES AND DISCRETIONS

That except insofar as legally or equitably permitted this Undertaking shall not prejudice or affect the exercise of any statutory duty or discretion of the Council or the County Council.

10. REASONABLENESS

That unless otherwise specified where any agreement certificate consent permission expression satisfaction or other approval is to be given under this Undertaking it shall not be unreasonably withheld or conditioned or delayed.

11. ALTERNATIVE PLANNING PERMISSIONS

That nothing in this Undertaking shall prohibit or limit the development of any part of the Site in accordance with any planning permission (other than the Planning Permission) granted either before or after the date of this Undertaking.

12. CONFIRMATION OF DISCHARGE OF PROVISIONS

- 12.1 That if the Owner requires from the Council or the County Council their written agreement that any of the obligations contained in this Undertaking have been met or fulfilled, they shall be entitled to apply in writing to the Council and/or the County Council (as appropriate) for such agreement.

13. PLOT PURCHASERS

That the obligations contained in the schedules of this deed shall not be binding on any purchaser lessee or mortgagee of a Dwelling nor against those deriving title from them SAVE THAT this clause shall not apply to the restrictions on the use of the Affordable Housing Dwellings.

14. THE CONTRACTS (RIGHTS OF THIRD PARTIES) ACT 1999

The Contracts (Rights of third Parties) Act 1999 shall not apply to this Undertaking and no person or persons other than the parties to this Undertaking and their successors (if any) as defined herein shall have any right under it nor shall it be enforceable by any person other than the parties to it and their successors in title (if any) as defined herein under that Act.

15. LOCAL LAND CHARGE

This Undertaking shall be a local land charge for the purposes of the Local land Charges Act 1975 and shall be registered as such.

16. DISPOSALS

In the event of the Owner disposing of its interest in the Site or any part thereof the Owner shall within twenty-eight days of such disposal give written notice of the name and address of its successors to the Council together with sufficient details of the land included in the disposal to allow its identification.

17. CONDITIONS

- 17.1 The financial contributions payable to the Council or County Council as appropriate under paragraph 4.1 and 4.2 of schedule 1 and paragraph 5.1 of schedule 2 (in this clause 17 referred to as the "Contributions") shall be paid on the following conditions:

- 17.1.1 upon receipt of the Contributions the Council or County Council as appropriate shall forthwith place the said contributions on deposit and apply them solely for the purposes stated in this Deed;

- 17.1.2 except in the case of paragraph 4.2 of schedule 1 if the Contributions have not been applied or arrangements for the application of all or any part of the Contributions have not been made within five years from the date of receipt of the same in accordance with this Deed then the Contributions or part thereof (as the case may be) shall become repayable to the Owner (here meaning the party who paid the Contribution) together with interest at the local authority seven day rate from the date of payment to the date of repayment;
- 17.1.3 in the case of paragraph 4.2 of schedule 1 only if the Rothwell Community Centre Contribution has not been applied or arrangements for the application of all or any part of the Rothwell Community Centre Contribution has not been made within ten years from the date of receipt of the same in accordance with this Deed then the Rothwell Community Centre Contribution or part thereof (as the case may be) shall become repayable to the Owner (here meaning the party who paid the Rothwell Community Centre Contribution) together with interest at the local authority seven day rate from the date of payment to the date of repayment;
- 17.1.4 that if requested to do so the Council or County Council as appropriate will produce to the Owner within 28 days of such request being made a statement of account as to how the Contributions or any part or parts thereof have been applied.

IN WITNESS where of the Owner has executed this Undertaking as a deed on the day and year first before written.

SCHEDULE 1: COVENANTS WITH THE COUNCIL

1. Affordable housing

1.1 As part of the application for approval of reserved matters pursuant to the Planning Permission the Owner shall submit plans to the Council identifying the proposed location and design of the Affordable Housing Dwellings for approval by the Council.

1.2 Thirty percent (30%) of the Dwellings shall be Affordable Housing Dwellings.

1.3 The Affordable Housing Dwellings shall not be used other than for Affordable Housing save that this obligation shall not be binding on:

1.3.1 any Protected Tenant or any mortgagee or charge of the Protected Tenant or any person deriving title from the Protected Tenant or any successor in title thereto and their respective mortgagees and chargees; or

1.3.2 any mortgagee or charge of the RSL or the successors in title to such mortgagee or charge or any receiver or manager (including administrative receiver) appointed pursuant to the Law of Property Act 1925;

1.3.3 any purchaser from a mortgagee of an individual Affordable Housing Dwelling pursuant to any default by the individual mortgagor.

1.4 Sixty percent (60%) of the Affordable Housing Dwellings shall be occupied as Social Rented Dwelling by tenants of the RSL and forty percent (40%) of the Affordable Housing Dwellings shall be occupied by way of Shared Ownership Dwellings.

1.5 The Owner will construct and complete the Affordable Housing Dwellings in accordance with the Design and Quality Standards published by the Housing Corporation (or future equivalent) immediately prior to Commencement of Development and pursuant to the Planning Permission.

SBJ 1.6 Not to Occupy more than ^{fifty} ~~eight~~ percent (⁵⁰ ~~80~~%) of the Market Dwellings until the Affordable Housing Dwellings have been built and transferred to an RSL.

SBJ 1.6A The Affordable Housing shall be distributed across the Development but shall be $\text{\textcircled{D}}$

1.7 The transfer of the Affordable Housing Dwellings to the RSL shall contain the following provisions:

1.7.1 the benefit of full and free rights of access both pedestrian and vehicular from the public highway to the Affordable Housing Land;

1.7.2 the grant and reservation of all rights of access and passage of services and other rights reasonably necessary to the beneficial enjoyment of the Affordable Housing Dwellings and the remainder of the dwellings constructed as part of the Development;

1.7.3 the imposition of such covenants as the developer of the site shall reasonably require as are consistent with the sale of any Dwellings within the Development.

1.8 In the event that the Owner (having used all reasonable endeavours to do so) has not been able to dispose of the Affordable Housing Dwellings to an RSL within six months of the offer to transfer the said Affordable Housing Dwellings to an RSL then the Owner may permit

SBJ $\text{\textcircled{D}}$ provided in one or more clusters of up to 15 Affordable Dwellings and utilize design techniques an objective of which is inter alia that the Affordable Housing Dwellings should be materially indistinguishable (in terms of outward design and appearance) from the Market Dwellings of similar size

Occupation of the remainder of the Market Dwellings free of the restriction at paragraph 1.6 above.

1.9 In the event that the Owner (having used all reasonable endeavours to do so) has not been able to dispose of the Affordable Housing Dwellings within one year of the offer to transfer the said Dwellings to an RSL the Owner shall be released from the obligations to provide the Affordable Housing Dwelling.

1.10 Percentage figures shall be rounded up or down to the nearest whole number.

2. Open Space

SBJ 2.1 Within 24 months from Occupation of the first ~~Market~~ Dwelling to lay out and construct to the Council's reasonable satisfaction the Open Space.

2.2 After the Open Space has been laid out in accordance with paragraph 2.1 above it shall thereafter be maintained for the Open Space Maintenance Period to the reasonable satisfaction of the Council.

2.3 No earlier than two months prior to the expiry of the Open Space Maintenance Period the Owner shall request the Council in writing to inspect the Open Space and shall following such inspection carry out such remedial works to the Open Space as are reasonably required by the Council (including the replacement of any dead or dying trees or shrubs) by the expiration of the Open Space Maintenance Period.

2.4 Following the Open Space Maintenance Period the Owner shall either:

2.4.1 confirm that it will take full responsibility for managing and maintaining the Open Space; or

2.4.2 transfer responsibility for managing and maintaining the Open Space to a Management Entity and in accordance with the Management Entity Protocol.

3. Play area

3.1 To provide and lay out the Play Area in accordance with details to be submitted to and approved by the Council.

3.2 The Play Area shall be laid out surfaced and equipped with play equipment as reasonably required by the Council.

SBJ 3.3 To ensure that the Play Area is laid out and provided as set out above within 24 months of Occupation of the first ~~Market~~ Dwelling.

3.4 After the Play Area has been laid out in accordance with paragraphs 3.1 and 3.2 above it shall thereafter be maintained for the Play Area Maintenance Period to the reasonable satisfaction of the Council.

3.5 Following the Play Area Maintenance Period the Owner shall either:

3.5.1 confirm that it will take full responsibility for managing and maintaining the Play Area; or

3.5.2 transfer responsibility for managing and maintaining the Play Area to a Management Entity and in accordance with the Management Entity Protocol.

4. Financial Contributions

- SBT 4.1 No later than Occupation of the ^{ninety per cent (90%)} ~~last~~ Market Dwelling the Owner shall pay to the Council the following contributions:
- 4.1.1 the Allotments Contribution as a contribution towards identified improvements at the allotments known as Bracher's Field allotments;
 - 4.1.2 the Rothwell Manor Park Contribution as a contribution towards the completion of a study commissioned to address the feasibility of restoring the historic features of Rothwell Manor Park;
 - 4.1.3 the Outdoor Sports Contribution as a contribution towards the drainage enhancement of the football pitch at Well Land Recreation Ground;
- 4.2 No later than Occupation of the 50th (fiftieth) Market Dwelling the Owner shall pay to the Council the Rothwell Community Centre Contribution as a contribution towards the proposed new community centre in Rothwell.

SCHEDULE 2: COVENANTS WITH THE COUNTY COUNCIL

1. Travel Plan

- 1.1 Not to permit any Dwelling to be Occupied before the Travel Plan has been agreed in writing with the County Council.
- 1.2 To implement the Travel Plan prior to Occupation of the First Dwelling and thereafter to comply with the Travel Plan.

2. HIST Pooled Contribution

- 2.1 To pay ten percent (10%) of the HIST Pooled Contribution Index Linked to the County Council upon or before Occupation of the first Dwelling.
- 2.2 To pay forty percent (40%) of the HIST Pooled Contribution Index Linked to the County Council upon or before Occupation of the 52nd (fifty second) Dwelling.
- 2.3 To pay fifty percent (50%) of the HIST Pooled Contribution Index Linked to the County Council upon or before Occupation of the 95th (ninety fifth) Dwelling or within three (3) years of Occupation of the first Dwelling whichever is the sooner.

2.4 Enhanced Bus Service Contribution

- 2.5 To pay the first instalment of the Enhanced Bus Service Contribution to the County Council upon or before Occupation of the first Dwelling.
- 2.6 To pay further instalments of the Enhanced Bus Service Contribution to the County Council on the first, second, third and fourth anniversaries of the first payment made under paragraph 2.5 above.

3. Conditions

- 3.1 The HIST Pooled Contribution and the Enhanced Bus Services Contribution payable to the County Council under this schedule 2 (in this paragraph 3 referred to as "the County Contributions") shall be paid on the following conditions:
 - 3.1.1 that the County Council confirms that the County Contributions shall be expended solely for the purposes stated in this Deed;
 - 3.1.2 that the County Council confirms that if any part of the County Contributions remains unspent or uncommitted on the tenth anniversary of the date when the Development is totally completed then the County Council shall upon written demand being made within three months of the said date refund to the Owner (here meaning the party who paid the County Contributions) within one calendar month of receiving such demand any such unspent or uncommitted sum together with interest at the local authority seven day rate from the date of payment to the date of repayment.

4. Footway/Cycleway Works and Public Transport Works

4.1 Prior to Occupation of the first Dwelling to:

4.1.1 undertake and complete the Footway/Cycleway Works to the adoptable standards of the County Council SUBJECT to all appropriate permissions notices and/or orders first being issued/confirmed in respect of any works affecting an existing public right of way;

4.1.2 undertake and complete the Public Transport Works to the adoptable standards of the County Council.

5. Financial Contributions

560 5.1 No later than Occupation of the ^{ninety per cent (90%)} ~~last~~ Market Dwelling the Owner shall pay to the County Council the following contributions:

5.1.1 the Library Contribution as a contribution towards library facilities in the vicinity of the Site; and

5.1.2 the Fire and Rescue Contribution as a contributions towards local fire and rescue infrastructure costs.

SCHEDULE 3: DESCRIPTION OF THE FOOTWAY/CYCLEWAY WORKS

1. Upgrade the existing public right of way that runs through the Site to Edinburgh Close, by constructing a 3 metre wide shared footway/cycleway bounded by 1.0 metre wide verges to adoptable standards with associated drainage works and renewal of styles, barriers or other such feature as may be agreed with the County Council at either end of the said public right of way.
2. Upgrade and improve the existing adopted footpath link from Meadow Road to Kettering Road with the construction of a shared use footway/cycleway to adoptable standards.
3. Upgrade and improve the length of public footpath reference UH17 between Elizabeth Road and Evison Road to improve the pedestrian environment.
4. Provide a new length of two metre wide footway on the southern side of Harrington Road from the proposed Site access to tie into the existing footway at a length of approximately 50 metres.
5. Provide dropped kerbs in the new length of footway on Harrington Road opposite the existing road narrowing and further dropped kerbs with tactile paving on the northern side to create a pedestrian cross point.
6. Provide tactile paving at the existing junctions on the identified walking routes shown for identification purposes only on Plan No 2.

Description of the Public Transport Works

7. Provide bus shelters, raised bus boarder kerbing, new flat signs and timetable displays of a type previously approved in writing with the County Council at the two existing bus stops on Harrington Road located between the junctions of Moorfield Road and Meadow Road to enhance accessibility especially for the mobility impaired and pushchair users.

ANNEX 1: PLANS

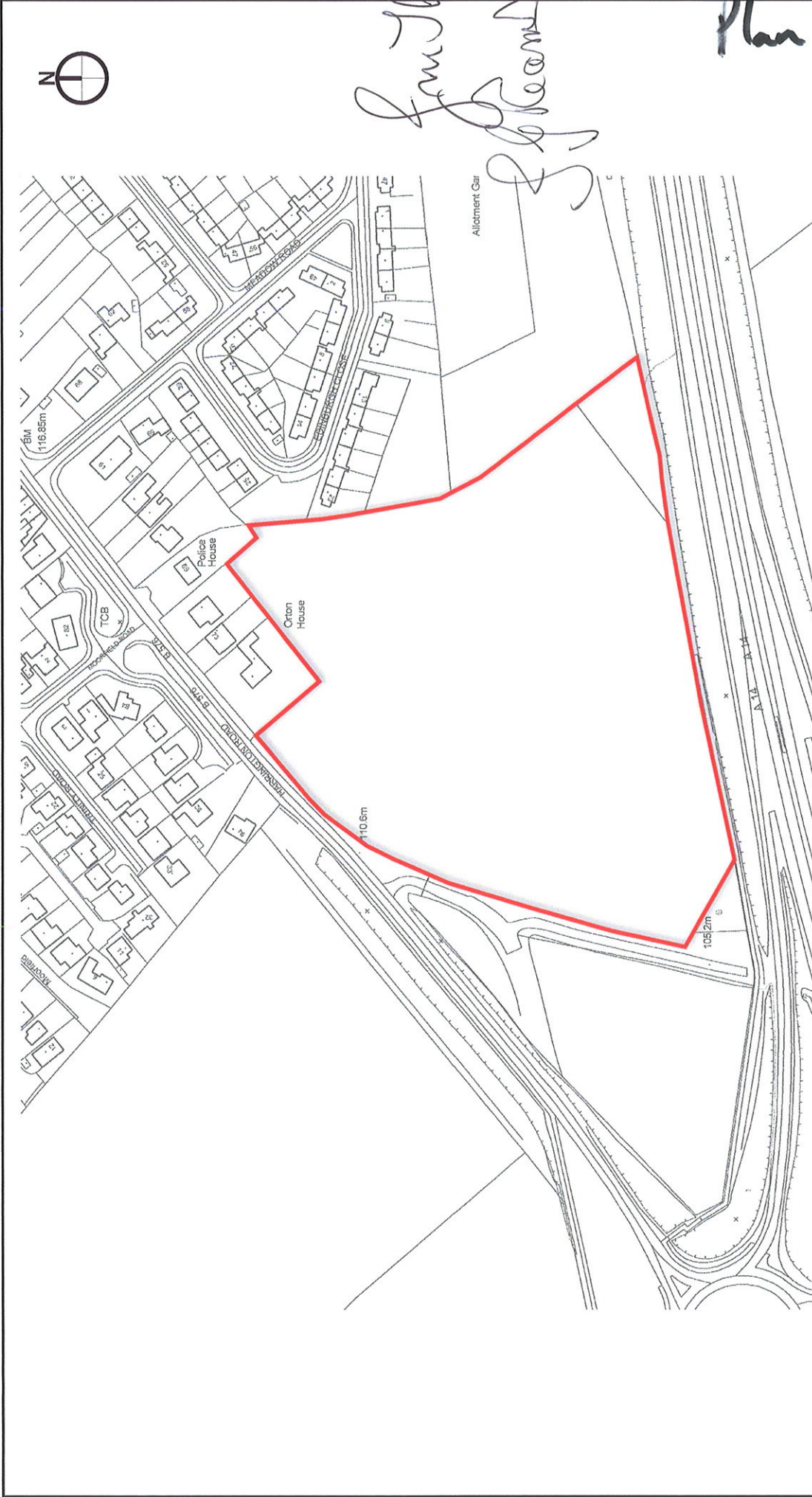

Plan No 1

From Thorne
S. of Ground

CLIENT
TRUSTEES OF MRS J THOMPSON (DECEASED)

PROJECT
LAND SOUTH OF HARRINGTON ROAD, ROTHWELL

Date	11.03.08	OS Ref.	SP810806	Drawn by	AA
Scale	1:2500@A3	Drawing no.	DLP/N157	Checked	
Job no.	N157	Area.	3.8 Ha		RP

DRAWING TITLE
SITE LOCATION PLAN

DLP PLANNING LTD
4 ABBEY COURT, FRASER RD, PRIORY BUSINESS PARK, BEDFORD MK44 3WH
T 01234 832 740
F 01234 831 266
E bedford@dipconsultants.co.uk
www.dipconsultants.co.uk

dip planning

OFFICES ALSO AT: BRISTOL, CARDIFF, READING AND SHEFFIELD

ANNEX 2: TRAVEL PLAN

For and on behalf of
TRUSTEES OF MRS J THOMPSON (DECEASED)

**DRAFT TRAVEL PLAN FOR
PROPOSED DEVELOPMENT OF LAND NORTH OF A14, ROTHWELL**

Prepared by
DLP Transportation Ltd

July 2009

Trustees of Mrs J Thompson (Deceased)

Prepared by:

Brendan Quinn

**Brendan Quinn
Associate Transport
Planner**

Checked by:

Tim Hayman

**Tim Hayman
Director**

Approved by:

Tim Hayman

**Tim Hayman
Director**

Date:

July 2009

DLP Transportation Ltd

2a High Street
Thornbury
Bristol
BS35 2AQ

Tel: 01454 410 380

Fax: 01454 410 389

DLP Consulting Group disclaims any responsibility to the client and others in respect of matters outside the scope of this report. This report has been prepared with reasonable skill, care and diligence. This report is confidential to the client and DLP Transportation accepts no responsibility of whatsoever nature to third parties to whom this report or any part thereof is made known. As such party relies upon the report at their own risk.

Contents

Page

1. INTRODUCTION	1
2. CONTEXT	3
3. OBJECTIVES OF THE TRAVEL PLAN	10
4. TRAVEL SURVEY	11
5. TRAVEL PLAN ACTION PLAN	14
6. MONITORING AND REVIEW STRATEGY	29
7. CONCLUSIONS	31

Figures

Figure 1 Location Plan

Appendices

Appendix 1 Example Travel Survey Questionnaires

Appendix 2 Accessibility and Audit Statement

1. INTRODUCTION

Brief

- 1.1 DLP Transportation Ltd. has been appointed by the Trustees of Mrs J Thompson (deceased) to prepare a Draft Travel Plan as part of the proposed re-development of land north of the A14 in Rothwell, Northamptonshire.
- 1.2 The proposed development is for the construction of 104 residential dwellings on currently undeveloped land. The application site is located between Harrington Road and the A14 at the south-west corner of Rothwell. The location of the site is shown on the attached **Figure 1**.
- 1.3 This document should be read in conjunction with the Transport Assessment that provides technical analysis of the proposed development.

Background

- 1.4 This report aims to provide a framework to enable the implementation of a detailed Travel Plan at the proposed site. The main aim of the final Travel Plan will be to facilitate and encourage sustainable travel behaviour, so that reliance on single occupancy car use for transport can be reduced.
- 1.5 At this stage a draft Travel Plan is most appropriate because, whilst the nature of the development will be established, it is an outline proposal and the type of accommodation, tenure and resident profile is yet to be finalised. The details of the Travel Plan cannot therefore be finalised as much will depend on the initial travel choices made by the users of the site. Therefore, as recommended by the Department for Transport best practice guidance in "Using the Planning Process to Secure Travel Plans" a draft Travel Plan has been developed.
- 1.6 The draft Travel Plan will provide a "route map" to develop and implement a detailed Travel Plan. The Travel Plan will identify tasks and measures that will need to be implemented prior to the opening of the development and outline the types of measures that could be used in the detailed Travel Plan. The overall aim of this Travel Plan is to enable a detailed residential Travel Plan to be developed and implemented. It is important to note that it is not a static document developed to address a transport problem at a single point in time. The document will evolve over time and accommodate improvements in local/regional transport infrastructure as appropriate.

Objectives and Scope of the Travel Plan

- 1.7 The main objective of the Travel Plan is to consider positive ways and methods by which the impact of the users of the site and the associated vehicular movements can

Trustees of Mrs J Thompson (Deceased)

be minimised and the accessibility improved through the implementation of the Travel Plan. Wherever possible, the Travel Plan will seek to maximise the efficiency of its initiatives by involving existing residents of Harrington Road and Rothwell in general.

- 1.8 The structure of the remainder of the Travel Plan is summarised below:
- Section 2 sets the scene and details the policy context within which the Travel Plan sits;
 - Section 3 details the aims of the Travel Plan;
 - Section 4 details the travel survey methodology;
 - Section 5 provides the Travel Plan Action Plan which details the effective delivery of the right mix of measures for the site;
 - Section 6 provides a monitoring and review strategy; and
 - Section 7 provides a summary and conclusions.

2. CONTEXT

What is a Travel Plan?

- 2.1 A Travel Plan seeks to reduce car use, encouraging alternative transport choices and reducing the need to travel. It sets aims and tangible targets so that 'real' change in transport behaviour can be achieved.
- 2.2 A clear definition of a Travel Plan is as follows:

“A Travel Plan is a long term travel management strategy built on a package of site-specific measures aimed at promoting sustainable travel, with an emphasis on reducing reliance on single occupancy car journeys and reducing the need to travel.”

- 2.3 The ultimate aim of any Travel Plan should be to influence long-term changes in travel behaviour by providing the right package of measures that promote and value sustainable transport initiatives. It is crucial to the success of a Travel Plan that the measures are **site specific** and tailored to the needs of the existing and future users of the site.
- 2.4 A Travel Plan is a dynamic process which will grow and develop with time, and with the changing circumstances of the site and the environment in which it works. It should be stressed that the Travel Plan will be flexible in which measures are implemented, and allow for changes to be made in line with Travel Plan performance.

Why a Travel Plan is required

- 2.5 A Travel Plan should be viewed as a positive tool that will have real benefit to the users of the site and to the surrounding area. By submission of this document the applicant is committing the developer of the site to implement the recommendations of this Travel Plan.
- 2.6 Travel Plans help to reduce the impact of travel on the environment and reduce costs for individuals and have a number of benefits such as:
- Helping to inform the design and operation of the development;
 - The Travel Plan, through promoting measures such as walking and cycling can help to improve the health of all users at the site.
 - The Travel Plan can reduce the cost of travelling to and from a site. The table overleaf illustrates the annual cost savings that could be made from car sharing based on the average car*.

Trustees of Mrs J Thompson (Deceased)

Round trip distance	10 miles	25 miles	50 miles
Annual savings	£892	£1050	£1270

* Figures and calculations from www.Liftshare.com

- Reduced congestion and improved access to the site. This has the knock on effect of reducing local pollution levels in terms of noise and harmful vehicle emissions such as carbon monoxide.
- Improves accessibility by facilitating and promoting sustainable transport initiatives, reducing reliance on the car.

Travel Plan Management

- 2.7 To ensure a long lasting Travel Plan legacy, it is crucial that there is the right management structure in place to continually support and drive the Travel Plan forward. Therefore, a Travel Plan Steering Group (TPSG) will be initiated so that Travel Plan implementation and monitoring will be well managed before, during and post completion of the residential development.
- 2.8 The make up of the TPSG will be different for pre-completion and post completion of the development. During the pre-completion of the development the TPSG will initially consist of:
- Developer,
 - Housing Associations,
 - Northamptonshire County Council Travel Plan Co-ordinator,
 - Northamptonshire County Council Transportation Officers as needed (i.e. cycling, public transport, school Travel Plans, public transport etc.) and
 - Public transport operators

Trustees of Mrs J Thompson (Deceased)

2.9 To drive the Travel Plan forward post completion of the development, it is intended that a Travel Plan Co-ordinator(s) from the group will be nominated for the site. The Travel Plan will therefore evolve so that it is no longer the responsibility of the developer, which will be reflected in the TPSG representatives which will exclude developer but include the following additional organisations and representation:

- Local Residents Association;
- Local Schools; and
- Residents on site.

2.10 It is recommended that meetings be held every quarter so that issues can be raised 'providing a 'voice' for the Travel Plan.

Travel Plan Co-ordinator

2.11 For a Travel Plan to succeed, it must be treated as an ongoing programme, requiring regular input. Experience has shown that the most successful Travel Plans have a dedicated Travel Plan Co-ordinator(s) (TPC) who is the main driving force for a particular site on a day-to day basis. The TPC is vital as they provide the focus for the Travel Plan to promote, implement and monitor it. Pre-occupation, the Sales Manager for the site, assisted by the sales team will act as the Travel Plan Co-ordinator. As stated above, this responsibility will be passed on to a nominated member(s) of the TPSG, post occupation.

2.12 To ensure a fully integrated Travel Plan, the TPC will therefore feed into the TPSG. The role of the TPC will be to co-ordinate the planning, surveying and promotion of the Travel Plan. In summary, the duties of the TPC are:

- Promoting and encouraging the use of alternative modes of transport;
- Providing information and updates to residents;
- Providing information and updates of Travel Plan measures;
- Arranging annual travel surveys;
- Liaising with public transport operators;

Local Transport Context

- 2.13 A key element of any Travel Plan is to undertake an audit of the local transport facilities to ascertain the accessibility of the application site in terms of walking, cycling and public transport facilities. The audit will identify possible improvements that can be made to enhance the accessibility of the site. Attached as **Appendix 2** is an Accessibility and Audit Statement for the application site.
- 2.14 The Accessibility and Audit Statement clearly shows the accessibility of the proposed site in relation to key services such as shops, education and transport. The site is located in an area with good quality footways in the vicinity of the proposed development. A section of footway will be installed along the site boundary on Harrington Road to aid pedestrian access to/from the site as will a section linking Meadow Road with Kettering Road (this is detailed in Section 5). The location of the proposed site in relation to public transport links should encourage the use of more sustainable modes of travel than single occupancy car use. This therefore goes towards meeting the aims and objectives of the Governments Planning Policy for sustainable development.
- 2.15 In developing this Travel Plan, care has been taken to ensure that UK best practice methods have been applied, and full regard has been given to these. The approach recommended in this Travel Plan takes account of a number of key policy documents (national, regional and local) which are designed to help deliver the maximum possible uptake of sustainable transport modes.

National Policy

- 2.16 National planning guidance from Planning Policy Statement 1: Delivering Sustainable Development (PPS1) and Planning Policy Guidance Note 13: Transport all emphasise the need for sustainable development with a need to increase travel choice and hence reduce dependency on car travel when planning for a new development.
- 2.17 PPS 1 states that states that local planning authorities should promote more efficient use of land through higher density development that is located to make the fullest use of public transport.
- 2.18 Planning Policy Guidance 13 – Transport, aims to integrate planning and transport at a national, regional and local level with the objectives of:
- Promoting more sustainable transport choices for people.
 - Promoting accessibility to jobs, shopping, leisure facilities and services by public transport, walking and cycling.
 - Reducing the need to travel, especially by car.

Trustees of Mrs J Thompson (Deceased)

- 2.19 Paragraphs 40 and 41 relate specifically to development in rural areas and provide an acknowledgement that in rural areas, the potential for using public transport and for non-recreational walking and cycling is more limited than in urban areas. However, the need for the same overall policy approach towards accessibility is not removed as it helps promote social inclusion and reduces isolation for those without use of a car.
- 2.20 Development, therefore, should be located in or near to local service centres, served by public transport and provide some potential for access by walking and cycling. The proposed site provides a natural extension of the long established residential area in Rothwell, which is immediately to the north east of the site. The proposed development will contribute to supporting the local services of the area such as leisure facilities, shops and schools. This accords with Planning Policy Guidance 13 'Transport' which states that:

“Local planning authorities should make sufficient land available either within or adjoining existing villages to meet the needs of local people but villages will only be suitable locations for accommodating significant additional housing where it can be demonstrated that additional housing will support local services, such as schools or shops, which could become unviable without some modest growth (this may particularly be the case where the village has been identified as a local service centre in the development plan), additional housing is needed to meet local needs, and the development can be designed sympathetically and laid out in keeping with the character of the village” (para. 15).

- 2.21 The transport objectives set out in PPG 13 are also reflected in Planning Policy Statement 3 'Housing'. Taken together, the national guidance provides a broad range of objectives for new residential development:

Trustees of Mrs J Thompson (Deceased)

- New housing should be linked to public transport nodes and defined corridors;
 - Personal choice should be increased by improving the transport alternatives to the private car;
 - Housing should be located such that people can carry out their everyday activities with less need to travel; and
 - It should be easier and safer to walk and cycle.
- 2.22 In July 2004, another Government White Paper entitled 'The Future of Transport' was published. This looks at the factors that will shape travel and transport over the next thirty years and sets out how the Government will respond to the increasing demand for travel, maximising the benefits of transport while minimising the negative impact on people and the environment.
- 2.23 The DfT has produced guidance on the successful implementation of Travel Plans. The guidance 'Making Residential Travel Plans: Good Practice Guidelines For New Development' provides detailed advice on all aspects of preparing a residential Travel Plan through an in-depth review of a number of case studies of specific residential schemes.
- 2.24 Research reports by the DfT such as "Smarter Choices: Changing the way we travel" (2004) and "Making Smarter Choices work" (2005) detail different types of Travel Plan measures and their effectiveness in reducing traffic levels to/from a site.
- 2.25 The Highways Agency Circular 02/2007: Planning and the strategic road network identifies the use of Travel Plans as a key demand management tool in reducing traffic generation and the impact of development on the strategic road network. This is through a variety of measures such as tailored provision of public transport, car sharing and the encouragement of walking and cycling.

Regional Policy

- 2.26 Both the Regional Spatial Strategy for the East Midlands (RSS8) and Milton Keynes & South Midlands Sub-Regional Strategy (MKSMSRS) address the need to reduce the number of car-based journeys in relation to new developments. Strategic Policy 3 of the Milton Keynes & South Midlands Sub-Regional Strategy requires that new developments should be designed with a view to-
- Ensuring good accessibility and providing better public transport
 - Facilitating safe and convenient movement on foot and by cycle
 - Reducing reliance on car-based transport

Local Policy

- 2.27 Travel Plans are recognised in the Second Northamptonshire County Council Local Transport Plan 2006 to 2011 as an integral part of reducing congestion on the County's roads. The LTP also recognises the role of travel planning in reducing the reliance on single occupancy car use where it requires;

"...more education to change attitudes with more people striving to achieve the vision through Green Travel Plans, School Travel Plans etc"

- 2.28 Northamptonshire County Council's "Transport Strategy for Growth" (2007) sets out the sustainable transport initiatives to accommodate the growth of the County over the coming years. A fundamental element of this Strategy is through 'smarter choices' and the implementation of Travel Plans, particularly for all new major developments. The Strategy identifies a 20% modal shift target for all new development.

3. OBJECTIVES OF THE TRAVEL PLAN

Introduction

- 3.1 It is important that the Travel Plan has a focus and direction in what it is trying to achieve. This can be accomplished through the identification of Travel Plan objectives, which are realistic and **site specific**.
- 3.2 Objectives:
- 1) To widen the travel options available to all users of the development. It is vitally important that the users of the development are made fully aware of the sustainable transport choices available to them from the opening of the site so that sustainable travel habits are established from the outset.
 - 2) To encourage less reliance on the car, wherever practicable, particularly for drive alone journeys. The measures contained in **Section 5** not only encourage and facilitate pedestrian and cycle use but also better use of the car through initiatives such as car sharing
 - 3) To improve the health of all users of the site. Current Government advice for living a healthier lifestyle is to engage in moderate exercise (that raises your breathing and heart rate) for 30 minutes a day. This Travel Plan aims to encourage greater take up of walking and cycling to the site within the area.
 - 4) To reduce the potential volume of traffic in and around the site. It is recognised that the development will generate some vehicle use. However, by implementing a robust Travel Plan, it is anticipated that much of this will be mitigated by the site specific measures on offer and will therefore lessen the number of vehicular trips per day to the site.
 - 5) To carefully monitor and manage the Travel Plan. It is imperative to the success of the Travel Plan that there are the right mechanisms in place to monitor and manage it so that it is effective year on year. Section 6 sets out a monitoring and review strategy.
 - 6) To reduce the potential volume of traffic in and around the site by setting **SMART** targets (**S**pecified-**M**easurable-**A**chievable-**R**ealistic-**T**imebound), with the main target of reducing single occupancy car use by 20%. This is in line with the target modal shift set for all new development as set out in Northamptonshire County Council's Transport Strategy for Growth (September 2007). The reduction of vehicular trips will be measured year-on-year by the travel surveys to guide and if necessary update the modal shift targets.

4. TRAVEL SURVEY

Travel Survey Methodology

- 4.1 Sustainable transport measures implemented as part of the Travel Plan must be viable in order for the Travel Plan to succeed. Residential Travel Plans differ from work place Travel Plans in that they deal with a more varied pattern of journeys from the place of origin. Therefore, the viability of residential Travel Plan measures differs slightly in that they are largely dependent upon the work and leisure activities of the residents and the location of their workplace or study. Travel surveys are vital in understanding the travel patterns of all users to the site and those that will occupy it in the future. By gaining an understanding of *actual and perceived* barriers to sustainable transport choices it will enable an assessment for the scope to influence modal shift.
- 4.2 Travel surveys will also identify what measures existing users of more sustainable modes (those that already car share, use public transport, walk and cycle) would like as part of the Travel Plan. This ensures that these users will feel *valued* and that behaviour will be *reinforced* by the measures on offer.
- 4.3 Travel surveys, in the form of a questionnaire survey at the site, will be conducted annually to compare changes in travel behaviour. **Appendix 1** provides examples of questionnaire surveys that could be used for the site.
- 4.4 The travel surveys will provide the basis for the modal shift targets. These are important as they provide the base from which comparisons can take place and they provide a focus for what the Travel Plan is trying to achieve. The surveys will be carried out at the same time (year-on-year) as the original baseline survey to ensure consistency. As a 'living document' measures within the Travel Plan can be adjusted/enhanced year-on-year in response to the travel survey results (see **Section 5** for the measures contained within the Travel Plan Action Plan).

Modal Shift Targets

- 4.5 Initial modal shift targets can be set even if the end users are not yet known, as in the case of this development. The initial modal shift targets are 'SMART' and are derived from Census Data for the Ward area (Tresham). The measures outlined in Section 5 are designed to:

"Reduce the reliance on single occupancy car use and encourage residents to consider more sustainable modes of transport when travelling to and from the site."
- 4.6 Therefore, in the absence of surveyed data, travel to work modal share data has been obtained using data from www.statistics.gov.uk broken down to Tresham Ward level.

Trustees of Mrs J Thompson (Deceased)

Table 1 details travel to work data (this is associated with the one of the busiest times of vehicular trip generation from a residential development, usually between 0800-0900), obtained from the above National Statistics website.

Table 1 – Tresham Ward Travel to Work Statistics

All people aged 16-74 in employment	942 people
People who work mainly at or from home	8.39%
People aged 16-74 who usually travel to work by: Train	0.74%
People aged 16-74 who usually travel to work by: Bus, Mini Bus or Coach	6.69%
People aged 16-74 who usually travel to work by: Motorcycle, Scooter or Moped	0.85%
People aged 16-74 who usually travel to work by: Driving a Car or Van	63.16%
People aged 16-74 who usually travel to work by: Passenger in a Car or Van	9.87%
People aged 16-74 who usually travel to work by: Bicycle	1.27%
People aged 16-74 who usually travel to work by: On foot	8.6%
People aged 16-74 who usually travel to work by: Other	0.42%
Average distance (km) traveled to fixed place of work	14.12 km

Trustees of Mrs J Thompson (Deceased)

- 4.7 From this, the initial baseline data for the modal share can be extracted and modal share targets set and these are detailed below in **Table 2**.

Table 2 – Modal Share Target for the Proposed Development

Mode of travel to work	Current 2008 baseline (%)	2010 (%)	2011 (%)	2012 (%)	2013 (%)	2014(%)
Bus	7	8	9	11	12	13
Cycle	1	2	3	4	5	6
Car (alone)	63	59	55	51	47	43
Car as passenger	10	11	12	12	12	13
Foot	9	10	10	11	12	13
Motorcycle	1	1	1	1	1	1
Train	1	1	1	1	1	1
Work from home	8	8	9	9	10	10
Totals	100	100	100	100	100	100

- 4.8 Whilst the targets above are based on census data for the Tresham Ward, they are **not site specific** and therefore **caution** needs to be applied until the first travel survey for site has been conducted and **actual** travel behaviour is understood. However, **Table 2** does provide the level of modal shift that the site should be aiming for, which is in line with the target modal shift set for all new development as set out in Northamptonshire County Council's Transport Strategy for Growth (September 2007). It is anticipated that by applying this robust Travel Plan it will reduce vehicle dependence and encourage sustainable modes of transport for occupants of the development. Therefore, a modal shift of **up to 20%** from single occupancy car use to more sustainable modes, after five years of occupation is considered achievable with the Travel Plan measures in place.

5. TRAVEL PLAN ACTION PLAN

Introduction

- 5.1 Key to the success of the Travel Plan is the identification of viable transport alternatives and these can be identified through the Travel Plan Action Plan. ***This is the package of measures derived from the travel surveys that should encourage a modal shift away from single occupancy car use and increase accessibility to and from the site.***
- 5.2 The implementation of the Travel Plan and the measures contained within it will be flexible. This will allow alterations and new measures to be introduced as and when required. The submission of the "living" Travel Plan document should not be viewed as a finite document, but a rolling programme of solutions that will continue to evolve and operate successfully in the long term.

Action Plan

- 5.3 A comprehensive list of measures has been identified for implementation. It should be noted that the Travel Plan is a rolling programme and should be reviewed and assessed after five years. Five years is considered an appropriate length of time to assess the Travel Plan and take stock of its progress.
- 5.4 Empirical evidence has shown that the optimum time for introducing people to alternative travel modes is when they experience a major life change event such as moving to a new house. The success of this residential Travel Plan will therefore depend on establishing a Travel Plan 'culture' of low car use among residents the moment they occupy their new homes. For the purposes of developing this Travel Plan it has been assumed that the first occupation on the site will be in January 2010. Therefore, some of the measures identified in the following Action Plan will be implemented pre-occupation i.e. December 2009.
- 5.5 The Action Plan has been broken down into five strategy sections and these are walking, cycling, public transport, car users and Travel Plan support measures.

Walking Strategy

Objective: 1,2, 3 and 6					
Target Modal Split: - Short/Medium Term 10%, - Long Term 13% Overall Modal Shift = 4%					
Actions		Timescale	Success Criteria / Monitoring and Evaluation	Responsibility	Funding/Resources
No.	Description	Month-Year			
W1	Develop a 'Safer Routes' walking map. This is a map showing the safest routes to the site. This should incorporate footpaths that are well fit and direct. Routes to destinations such as the local bus stops should be highlighted. Contact Northamptonshire County Council on 01604 654440	November 2009	<ul style="list-style-type: none"> • Take up of maps • Feedback from travel surveys 	Travel Plan Co-coordinator/NCC	In conjunction with NCC as this could be developed into an area-wide map incorporating some or all of Rothwell. Approximate cost - £5,000

Trustees of Mrs J Thompson (Deceased)

W2	<p>Improved network provision. There is currently no footway on Harrington Road, adjacent to the proposed access on the site boundary. The footway begins approximately 40m east of the proposed access. Therefore a footway link will be provided. This is a direct link into Rothwell High Street. Harrington Road does not currently have a pedestrian crossing point. A road narrowing/chicane is located opposite the site access. Drop kerbs will be installed on the chicane and the footway to improve accessibility. The site will benefit from two pedestrian access points on Harrington Road and Edinburgh Close. The public right of way at the south eastern corner of the site will be upgraded to allow both pedestrians and cyclists a more direct link with Edinburgh Close/Kettering Road. A short section leading from Meadow Road to Kettering Road will also be upgraded to enable pedestrian and cycle access.</p>	October 2009	<ul style="list-style-type: none"> Feedback from travel surveys 	TPC/NCC	<p>40m footway on Harrington Road - £4,000 Upgrade of public right of way on site to 3m footway/cycleway - £60,000 Footway/cycleway section to link with Kettering Road - £6,000 Total approximate cost - £ 70,000</p>
W3	<p>Obtain discounts from local sports shoe shops. Negotiate with local sports wear company a discount scheme i.e. 10% discount on proof of address for sports footwear/clothing to encourage take up of walking.</p>	January 2010	<ul style="list-style-type: none"> Number of users of discount scheme Feedback from travel surveys 	TPC	Time of the TPC

Trustees of Mrs J Thompson (Deceased)

W4	<p>Promoting walking as a healthier way to travel. Leaflets can be obtained via Northamptonshire Teaching Primary Care Trust which is located at: Bevan House, Keffering Parkway, Keffering Venture Park, Keffering, Northamptonshire NN15 6XR Tel: 01536 480300</p>	January 2010	<ul style="list-style-type: none"> • Take up of leaflets • Feedback from travel surveys 	TPC	Leaflets can be obtained free from PCT
W5	<p>Walking Bus. The developer will work with the Travel Plan Officer at Northamptonshire County Council and the infant/junior schools in the area (Victoria Infants School and Rothwell Junior School – both within approximately 1400 m from the proposed site) to introduce "walking buses" to and from the schools to the proposed site. This would reduce journeys made in the 'school run' therefore further assisting the meeting of the Travel Plan aims. The developers would be willing to provide hi-visibility vests for children to wear and umbrellas for wet weather when walking to and from the local schools.</p>	February 2010	<ul style="list-style-type: none"> • Year-on-year increase in the number of children participating in the walking bus scheme • Take up of number of vests 	TPC	Approximate cost £500

Trustees of Mrs J Thompson (Deceased)

W6	<p>Contact Northamptonshire Police HQ for advice on the types of alarms suitable for residents. Northamptonshire Police HQ Wootton Hall, Wootton Park, Northampton, Northamptonshire NN4 0JQ Tel: 01604 700700</p>	January 2010	<ul style="list-style-type: none"> • Take up of alarms • Feedback from travel surveys 	TPC	Approximate cost - £500
----	---	-----------------	---	-----	-------------------------

Cycling Strategy

Objective: 1,2, 3 and 6					
Target Modal Split: - Short/Medium Term 2%, - Long Term 6% Overall Modal Shift = 5%					
Actions		Timescale	Success Criteria / Monitoring and Evaluation	Responsibility	Funding/Resources
No.	Description	Month-Year			
C1	Develop a 'Safer Routes' walking map. This could be in conjunction with measure W1, to produce a combined walking and cycling map. Contact Northamptonshire County Council on 01604 654440	November 2009	<ul style="list-style-type: none"> • Take up of maps • Feedback from travel surveys 	TPC/NCC	In conjunction with NCC as this could be developed into an area-wide map incorporating some or all of Rothwell. Approximate cost - £5,000
C2	Provision of secure cycle parking. All houses will be provided with a Sheffield stand. A secure cycle parking area with cycle lockers will be implemented for flats which will be in a centrally located well-lit area.	November 2009	<ul style="list-style-type: none"> • Cycle parking surveys 	Travel Plan Co-coordinator/NCC	Approximate cost - £2,000

Trustees of Mrs J Thompson (Deceased)

C3	Improved network provision to and from the site. See measure W2 for details	October 2009	<ul style="list-style-type: none"> Feedback from travel surveys 	TPC/NCC	See measure W2 for cost details
C4	Obtain discounts from local cycle shops. Negotiate a discount scheme i.e. 10% discount on proof of address for cycles/equipment to encourage take up of cycling.	January 2010	<ul style="list-style-type: none"> Number of users of discount scheme Feedback from travel surveys 	TPC	Time of the TPC
C5	Promote cycling as a healthier way to travel to work. See www.sustrans.org.uk for cycle events such as National Bike to Work Week and contact Northamptonshire Teaching Primary Care Trust which is located at Bevan House, Kettering Parkway, Kettering Venture Park, Kettering, Northamptonshire NN15 6XR Tel: 01536 480300	January 2010	<ul style="list-style-type: none"> Take up of leaflets Feedback from travel surveys 	TPC	Leaflets can be obtained free from PCT

Trustees of Mrs J Thompson (Deceased)

C6	<p>Cycle training. The promotion of cycle training will be recommended, which will be of particular use to adults who have not cycled in a long time or for children wanting to increase their cycle proficiency. A budget will be available for training by the developer and volunteers will be sought to become trainers. Contact : Cycle Training UK Unit 215, Building J 100 Clements Road London SE16 4DG Tel: 020 7231 6005</p>	January 2010	<ul style="list-style-type: none"> • Take up of scheme • Feedback from travel surveys 	TPC	Approximate cost for two lessons per person (up to 60 residents) at £30 per hour - £1,800
C7	<p>Establish a BUG (Bicycle User Group). This will provide a voice for cyclists and ensure that there will be a constant input from those that cycle and the issues they may have as part of the Travel Plan. This would require regular meetings and a resident to be overall co-ordinator on behalf of the residents (this should not be the TPC)</p>	January 2010	<ul style="list-style-type: none"> • Number of members 	TPC/BUG	Time of the TPC/BUG co-ordinator

Public Transport Strategy

Objective: 1, 2, 3, 4 and 6						
Target Modal Split: - Short/Medium Term 8%, Overall Modal Shift = 8% - Long Term 13%						
Actions		Timescale		Success Criteria / Monitoring and Evaluation	Responsibility	Funding/Resources
No.	Description	Month-Year				
P1	Promotion of public transport information/ timetables. Studies have shown that a lack of information/marketing of public transport is a key deterrent as to why people don't use public transport. Leaflets from the bus operating companies with buses that run near the site are to be made available. Contact Northamptonshire County Council, Sustainable Transport, Riverside House, Riverside Way, Northampton, NN1 5NX Tel 01604 654306	December 2009		<ul style="list-style-type: none"> Feedback from travel surveys 	TPC	Time of the TPC

Trustees of Mrs J Thompson (Deceased)

P2	<p>Enhancements to existing bus service. This will involve extending the No. 18 service into the evening to capture return from work trips and Sunday running to capture predominantly retail and leisure trips. By enhancing the services in that manner, new residents will be encouraged onto the service and existing residents may also take advantage of the services, thus further reducing the impact of the development and assisting in meeting Travel Plan Targets.</p>	December 2009	<ul style="list-style-type: none"> • Increase in bus patronage • Feedback from travel survey 	TPC	<p>Using existing buses the cost the additional cost would be:</p> <p>Mon-Sat eve 306 days p.a. x £30 per hour x 5 hours = £45k p.a.</p> <p>Sun and Bank Holiday 57 days p.a. x £35 per hour x 16 hours = £32k p.a.</p> <p>Total cost per annum - £77,000</p>
----	--	---------------	--	-----	---

Car Users Strategy

Objective: 1,2,3, 4 and 6					
Target Modal Split: - Short/Medium Term 59%, - Long Term 43%					
Overall Modal Shift = 20%					
Actions		Timescale	Success Criteria / Monitoring and Evaluation	Responsibility	Funding/Resources
No.	Description	Month-Year			
C1	<p>Car share database. Residents and perspective buyers will be informed at the 'selling' of the units by the sales team how users can access a car share database website: This includes sites such as</p> <ul style="list-style-type: none"> • www.travelsmartuk.com • www.liftshare.com • www.school-run.org <p>There will be an intensive promotion of car sharing through leaflets, the Travel Plan webpage, Travel Information boards and in the Residents Travel Plan Pack (Measures T1, T2 and T4 respectively)</p>	November 2009	<ul style="list-style-type: none"> • Number of hits • Feedback from travel survey 	On-site site sales staff and TPC	Time of the TPC

Trustees of Mrs J Thompson (Deceased)

C2	<p>Promotion of car sharing. This will be initially through the on-site sales staff and then the TPC. Sales staff will promote the benefits of car sharing which will be continued by the TPC through leaflets/posters advertising the benefits of car sharing i.e. reduced cost, stress.</p>	November 2009	<ul style="list-style-type: none"> • Number of hits • Feedback from travel survey 	On-site site sales staff and TPC	Time of the TPC
----	---	---------------	---	----------------------------------	-----------------

Travel Plan Support Strategy

Objective: 1, 2, 3, 4 and 6						
Target Modal Split: - Short/Medium Term 9%, Overall Modal Shift = 2% - Long Term 10%						
Actions		Timescale		Success Criteria / Monitoring and Evaluation	Responsibility	Funding/Resources
No.	Description	Month-Year				
T1	A Travel Plan page will be set up on the website for the site which will be set up prior to occupation. The Travel Plan page will outline the aims of the Travel Plan and will detail the measures on offer (this will include links to the car share website and walking, cycling maps etc.). With more and more people having access to a computer (whether it be at home or at work), a Travel Plan internet page provides a convenient and accessible way to promote and implement the Travel Plan to the residents.	November 2009		<ul style="list-style-type: none"> • Number of hits • Feedback from travel survey 	TPC	Time of the TPC and as part of the cost to set up the website for the development

Trustees of Mrs J Thompson (Deceased)

T2	<p>Travel Plan Information Boards. The sales and marketing literature for promoting the site to prospective buyers will place clear emphasis on the Travel Plan, using it as a unique selling point for the development, and communicating its aims and objectives. Therefore, information boards will be located outside the sales office from the first day that it is open. This will provide an immediate promotion of the Travel Plan and the benefits of it. These boards will be regularly updated to ensure that the latest Travel Plan information is available.</p>	October 2009	<ul style="list-style-type: none"> • Feedback from travel survey 	TPC	Information board, approximate cost £200.
T3	<p>Personalised Travel Planning. This service will be available pre and post occupation. Sales staff will be trained to advise those that have bought houses the travel options available to residents for commuting etc. Post occupation, the TPC will also be trained to do this.</p>	October 2009	<ul style="list-style-type: none"> • Feedback from travel survey 	On-site sales staff/TPC	Time of the on-site sales staff and TPC

Trustees of Mrs J Thompson (Deceased)

T4	<p>When residents complete on their property they will receive a Residents Travel Plan Pack (RTPP). This will be available to all residents (rented, private, shared equity and affordable housing) and will be available to any new residents for the 'life' of the Travel Plan. The RTPP will provide up to date details on the following:</p> <ul style="list-style-type: none"> - Details of the Travel Plan including its aims, benefits and sustainable transport advice. - Public transport timetables (bus and rail). - Contact details of the Travel Plan Co-ordinator, NCC Cycling Officer, local bus and rail operators - Pedestrian and cycle route maps from the development, specifically to the town centre and local schools. The maps will also show local amenities such as supermarkets and bus stops near the site i.e. on Harrington Road. - Where they can get discounts on new bicycle purchase and cycle accessories. - Advice on how to become a member of the Travel Plan Steering Group. - The menu of Travel Plan measures on offer. -- Promotion of a Travel Plan internet page. - Details of the car sharing database. 	November 2009	<ul style="list-style-type: none"> • Feedback from travel survey 	TPC	Approximate cost - £7,000
----	---	---------------	---	-----	---------------------------

6. MONITORING AND REVIEW STRATEGY

Annual Review and Monitoring Process

- 6.1 The ongoing monitoring and review of the Travel Plan is a vital component in assessing progress and for highlighting any changes that may be required in the Travel Plan to meet the targets set. As a 'living manual' the Travel Plan can adapt to changes in travel behaviour highlighted in the annual travel survey.

Traffic and travel surveys

- 6.2 The principal objectives of the Travel Plan is to reduce the number of vehicles travelling to the site – with the emphasis on reducing single occupancy vehicles travelling to the site and the number people being dropped off. This will be achieved through encouraging and promoting more sustainable modes of travel from the measures identified in the Travel Plan. The best indicator of the success of the Travel Plan is the modal split as detailed in **Table 2**.
- 6.3 Therefore, traffic surveys and travel surveys are a key component of the Travel Plan. The surveys will highlight those measures that are not performing, thereby enabling changes to be made if necessary.
- 6.4 The traffic monitoring will be undertaken by vehicle counts using loops (or other agreed methods) at the access to the site off Harrington Road to quantify the number of car trips being generated by the site. It is proposed that monitoring of traffic movements into and out of the site together with a travel surveys be carried out over a typical week in December of each year.
- 6.5 It will be important to ensure that the vehicle counts take place over a 'typical' week, i.e. not during public holidays, or when there are major events on site and as far as is possible, not during particularly exceptional weather. The traffic and travel surveys will provide a robust base for data against which the Travel Plan targets will be measured.

Travel Plan monitoring and review schedule

- 6.6 To follow is a Monitoring and Review Schedule which identifies the key milestones of the Travel Plan. The schedule is set for five years after the site is occupied which will ensure that sustainable travel patterns have been established and is a convenient point with which to review the Travel Plan as a whole. It must be emphasized that the Travel Plan is a 'living' document and the developer has committed to this and the ongoing monitoring and review process after the five year period.

Table 3 – Travel Plan Monitoring and Marketing Strategy

Date to action	Action	How	NCC/HA	When to submit portfolio
October 2009	Appoint TPC pre-completion	Appointed by the Sales Team	To be informed.	
January 2010	Appoint TPC post completion	Appointed from within the Travel Plan Management Group	To be informed.	
January 2010	Travel Plan implemented	Initial promotion, launch of significant measure(s)	To be informed of implementation and initiatives in advance	April 2010
<i>Baseline Survey and audits as agreed with NCC no later than April or 50% occupancy</i>				
YEAR ONE SCHEDULE				
June Yrs 1,2,3,4,5	Travel issues	Update database of travel issues raised by residents	Add results summary to portfolio	
December Yrs 1,2,3,4,5	Traffic Survey	Install Automatic Traffic Counter (ATC) at site entrance to ascertain trip rates.	Add results summary to portfolio	January
June Yrs 2,4	Snapshot survey	Undertake modal share survey of residents travel patterns	Record Modal Shares in portfolio	July
December Yrs 1,2,3,4,5	Full travel survey and review	Undertake comprehensive travel survey of site users	Record Modal Shares in portfolio	January
January Yrs 2,3,4,5	Annual Review	Collate, analyse and interpret all results and evidence of success and use to review Travel Plan effectiveness against set targets. Build action plan for the following year. Review targets if necessary	Portfolio of evidence and data to be submitted; meet with NCC officer to discuss progress and issues	February

7. CONCLUSIONS

- 7.1 This Travel Plan provides a 'route map' for producing the detailed Travel Plan for the site. The success of the Travel Plan lies very much in the hands of the Travel Plan Co-ordinator with support from the Travel Plan Management Group. The Travel Plan Co-ordinator will need to ensure that the Travel Plan is constantly promoted and updated, as this is required for it to remain focused.
- 7.2 The detailed Travel Plan will be underpinned by strong support work in terms of analysing travel survey data. As a 'living document' this will enable the production of a robust and comprehensive Travel Plan. The modal shift targets, which will aid the future monitoring of the Travel Plans will be based on the travel survey data and act as a guide for the progression of the Travel Plans.
- 7.3 By securing the implementation of a robust Travel Plan, the developer will show their commitment to establishing sustainable travel behaviour to the site from the **very outset of occupation**.

FIGURE 1

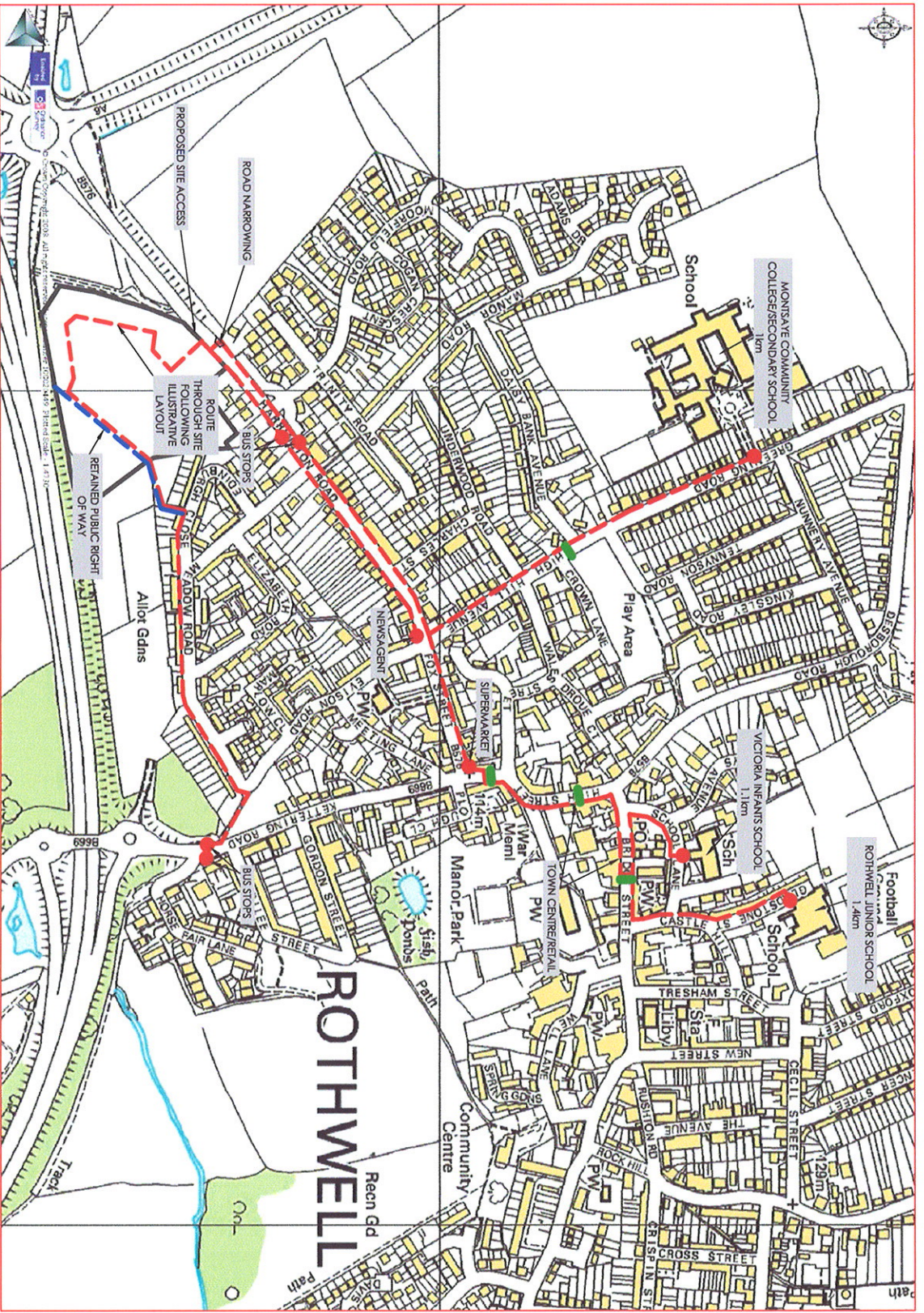

- KEY**
- WALKING ROUTE
 - PEDESTRIAN CROSSING
 - PUBLIC RIGHT OF WAY

Based upon the Ordnance Survey Map with the permission of the controller of H.M. Stationery Office © Crown Copyright Licence No. 100048330

Client
TRUSTEES OF MRS. J. THOMPSON (DECEASED)

Scale 1:5000
 Sheet A3
 Shown on Original

Project
LAND NORTH OF A14, ROTHWELL

The
PLAN OF LOCAL WALKING ROUTES

dtp transportation

25A HIGH STREET, THORNHALL
 BIRMINGHAM, B32 3XD
 TEL: 0121 717 0000
 FAX: 0121 717 0001
 dtp@transportation.co.uk
 Also at: Bristol, Cardiff, Reading & Sheffield

Project No. NI57-IT-01
 Issue No. 01

APPENDIX 1

Residents Travel Survey Questionnaire

A Travel Plan is being developed at this site with the aim of making your everyday journeys easier and cheaper whilst at the same time trying to encourage more use of the bus, walking, cycling and car sharing. Please could you spend a little time filling this questionnaire in and return to.....

1. Are you currently:

- Employed
- A Student
- Retired
- Not currently employed

2. If you are employed what is your main mode of travel to work? (if not currently employed go to 5)

- Bus
- Walking
- Cycling
- Motorcycle
- Car, on own
- Car, a driver with passenger(s)
- Car as a passenger
- Taxi
- Train
- Work from home
- Other, please state _____

3. How far do you travel to work?

- Less than 1 mile
- Less than 3 miles
- Less than 5 miles
- Less than 10 miles
- Less than 20 miles
- Over 20 miles
- Other, Please state _____

4. What is your typical time you leave and return home from work?

Usual time leave for work _____
Usual time return from work _____

5. If you are not currently employed what is your main mode of travel?

- Bus
- Walking
- Cycling
- Motorcycle
- Car, on own
- Car, as a driver with passenger(s)
- Car as a passenger
- Taxi
- Train
- Other, please state _____

6. Do you have a disability which affects your travel arrangements?

- Yes
- No

7. Which alternative would you use if your normal mode of transport was unavailable?

- Bus
- Walking
- Cycling
- Motorcycle
- Car, on own
- Car, as a driver with passenger(s)
- Car passenger
- Taxi
- Train
- Work from home
- Other, please state _____

8. Which of the following would encourage you to walk more (if you already walk as main mode of transport what would you like to see)?

- Better footways leading from the site
- Walking map
- Personal alarms
- Hi-visibility clothing
- None
- Other _____

9. Which of the following would encourage you to cycle (if you already cycle what would you like to see)?

- Discounts on bikes and accessories
- Secure cycle parking
- Hi-visibility clothing
- Provision of waterproof clothing
- Promotion of health benefits
- Cycle training
- None
- Other _____

10. Which of the following would encourage you to use the bus (if you already use the bus what would you like to see)?

- Better bus stop facilities
- Discounts on tickets
- More frequent services
- Timetable information
- More convenient drop off points
- None
- Other _____

APPENDIX 2

For and on behalf of
TRUSTEES OF MRS J THOMPSON (DECEASED)

**ACCESSIBILITY AND AUDIT STATEMENT FOR THE PROPOSED DEVELOPMENT
OF LAND NORTH OF A14, ROTHWELL**

Prepared by
DLP Transportation Ltd

November 2008

TRUSTEES OF MRS J THOMPSON (DECEASED)

Prepared by:

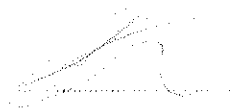

Lee Stoney

Senior Transport Planner

Checked by:



Tim Hayman

Director

Approved by:

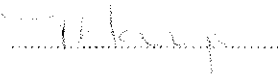

Tim Hayman

Director

Date:

November 2008

DLP Transportation Ltd

2a High Street
Thornbury
Bristol
BS35 2AQ

Tel: 01454 410 380

Fax: 01454 410 389

DLP Consulting Group disclaims any responsibility to the client and others in respect of matters outside the scope of this report. This report has been prepared with reasonable skill, care and diligence. This report is confidential to the client and DLP Transportation accepts no responsibility of whatsoever nature to third parties to whom this report or any part thereof is made known. As such party relies upon the report at their own risk.

CONTENTS

Figures

Figure 1 Plan of Local Walking Routes

Appendices

Appendix A Bus Timetable – Service 18
Appendix B Bus Timetable – Service 19
Appendix C Bus Timetable – Service 304

Introduction

This statement has been prepared by DLP Transportation Ltd (DLPT) in relation to a proposed development at land north of A14 in Rothwell, for 117 no. residential dwellings.

The purpose of this statement is to examine the accessibility of the application site in terms of walking, cycling and public transport facilities and its connectivity to essential and non-essential services within the area.

Site Location

The site is located at the south-eastern corner of Rothwell adjacent to the A14. The site is bounded by Harrington Road to the north and the A14 to the south. Harrington Road is a predominantly residential road linking into Rothwell High Street located approximately 600m east of the application site. To the west, Harrington Road links into the A6/A14 roundabout located approximately 300m from the application site.

The A14 to the south is the main arterial route between the M6 to the west and towards Felixstowe to the east. The A14 directly links Rothwell with Kettering, located approximately 4.5km east of the application site.

Site Access

The development proposals show that the site will be accessed from Harrington Road. There is an existing pedestrian-only access through the site from Edinburgh Close to the east, linking to the A14 to the south. This route is a retained public right of way (footpath UH4) that is unmade.

Public Transport

Bus stops are located on Harrington Road near to the junction with Moorfield Road. The stops are located approximately 100m east of the proposed development access and approximately 350m from the farthest point within the site. There are currently no bus shelters, timetable displays or raised kerbs in place at these stops.

From these stops a regular bus service runs to Kettering, Desborough and Market Harborough on weekdays and Saturdays. Bus service 18 is able to be used as a commuter service to Kettering, Desborough and Market Harborough during the early AM and late PM periods. The following tables summarise the AM and PM peak services from Harrington Road whilst the full timetable is attached as **Appendix A**.

Trustees of Mrs J Thompson (Deceased)

Destination	Times from Harrington Rd, Rothwell	Destination Arrival Times	Average Travel Time (mins)
Kettering (Rockingham Road)	0809, 0934	0826, 0951	17
Desborough (High Street)	0815, 0915	0824, 0924	9
Market Harborough (Market Hall)	0700, 0815, 0915	0724, 0845, 0945	28

AM outbound buses from Harrington Rd, Rothwell (Service 18 – Monday to Friday)

Origin	Times from origin	Destination Arrival Times	Average Travel Time (mins)
Kettering (Rockingham Road)	1659, 1759	1715, 1815	16
Desborough (High Street)	1717, 1827	1734, 1844	17
Market Harborough (Market Hall)	1705, 1815	1734, 1844	29

PM inbound buses to Harrington Rd, Rothwell (Service 18 – Monday to Friday)

Destination	Times from Harrington Rd, Rothwell	Destination Arrival Times	Average Travel Time (mins)
Kettering (Rockingham Road)	0809, 0934	0826, 0951	17
Desborough (High Street)	0815, 0915	0824, 0924	9
Market Harborough (Market Hall)	0700, 0815, 0915	0725, 0845, 0945	28

AM outbound buses from Harrington Rd, Rothwell (Service 18 – Saturdays)

Land North of A14, Rothwell

Trustees of Mrs J Thompson (Deceased)

Origin	Times from origin	Destination Arrival Times	Average Travel Time (mins)
Kettering (Rockingham Road)	1659, 1759	1715, 1815	16
Desborough (High Street)	1626, 1726, 1836	1634, 1734, 1844	8
Market Harborough (Market Hall)	1705, 1815	1734, 1844	29

**PM inbound bus to Harrington Rd, Rothwell
(Service 18 – Saturdays)**

As the previous tables show, buses are available to take commuters to these destinations before 9am. It is considered that there is scope to improve the frequency of the evening return journeys as there are longer periods between services. There is currently no Sunday service from Harrington Road.

Further bus services are available from Kettering Road and the High Street. Bus service 19 offers a higher frequency of buses to Kettering and Desborough throughout the day. The service operates Mondays to Saturdays and has a limited service on Sundays. The service is summarised in the following table, whilst the full timetable is attached as **Appendix B**.

Route	Frequency
Desborough – Rothwell – Kettering	0652, 0712, 0732, 0757, 0817, 0847, 0907, 0927 then every 20 mins until 1707, 1732, 1752, 1812, 1852, 1912, 2012, 2112, 2217, 2347
Kettering – Rothwell – Desborough	0649, 0709, 0729, 0754, 0824, 0844, 0904, 0924 then every 20 mins until 1644, 1709, 1729, 1749, 1809, 1829, 1849, 1949, 2049, 2149, 2319

Summary of Bus Service 19

Bus stops for Service 19 are located on Kettering Road and the High Street. The stops can be accessed via two walking routes, that are shown on the attached **Figure 1**.

Bus service 304 also calls at these stops, although the service offers only one journey per day in each direction to Northampton and Desborough. The full timetable is attached as **Appendix C**.

Trustees of Mrs J Thompson (Deceased)

The closest railway station is in Kettering located approximately 6.5km southeast of the application site. The station is located on the Midland Main Line and is served by regular trains to London St. Pancras, Derby, Nottingham and Luton. The following table summarises the current frequency.

Destination	Frequency from Kettering between 0700 & 1000hrs	Frequency to Kettering between 1700 & 1900hrs	Journey Time (mins – approx)
London St. Pancras	Approx every 15-20 mins	Every 15 mins	50 – 65
Derby	Approx every hour	Every hour	60
Nottingham	Approx every hour	Every hour	60
Luton	Approx every 20-60 mins	Approx every 40 mins	40

Service Frequency from Kettering Railway Station

Bus services 18 and 19 can be used as a direct link with Kettering Station providing good connectivity with the services above. Bus stops in Kettering are located on Sheep Street outside Kettering Library a short walk (350m) to and from the railway station.

Walking

There is currently no footway on the southern side of Harrington Road adjacent to the site. The footway begins approximately 50m east of the proposed access. There is a continuous footway on the northern side of the road. From this point the footway network to facilities in Rothwell is excellent. Harrington Road provides a direct link to the Kettering Road and the High Street to the east, with pedestrian crossings providing a safe walking route to the main retail sector of Rothwell.

Harrington Road does not currently have a pedestrian crossing point. A road narrowing/give way is located just to the east of the proposed site access. The narrowing provides for the safer crossing generally of Harrington Road, as traffic travelling the A14/A6 roundabout has to give way to oncoming vehicles. It is considered that this could be used as a crossing point if drop kerbs are installed on the build-out and on the proposed site side, to improve accessibility.

Land North of A14, Rothwell



Road Narrowing Opposite Proposed Site Access

Good street lighting is available along Harrington Road, however the columns are only located on the northern side of the road adjacent to the site.

As previously discussed, the application site will benefit from two pedestrian access points, one with Harrington Road and the existing public right of way to Edinburgh Close.



Existing Public Right of Way Access from Edinburgh Close

Trustees of Mrs J Thompson (Deceased)

The following table is an extract from 'Providing for Journeys on Foot' which was published by the Institute of Highways and Transportation and shows acceptable walking distances to various facilities. A plan of the following routes is attached as **Figure 1**.

	Town Centres	Communting/School/ Sight-seeing	Elsewhere
Desirable	200	500	400
Acceptable	400	1000	800
Preferred Maximum	800	2000	1200

Suggested Acceptable Walking Distances (Providing for Journeys on Foot – IHT)

A survey of walking routes was carried out in November 2008 to establish the desire routes and existing facilities. the following table summarises the main facilities within Rothwell and their distance from the application site. The distances have been taken from the farthest south westerly point within the site to demonstrate the longest distance needed to travel and the time involved. A walking speed of 1.4m per second has been used to determine travel times, as shown in 'Providing Journeys on Foot'.

Trustees of Mrs J Thompson (Deceased)

Destination/Facility	Desirable Walking Route	Distance from Site	Travel Time (mins)
Bus stops – Harrington Road	Harrington Road	350m	4.16
Bus Stops – Kettering Road	Edinburgh Close – Meadow Road – Elvison Road footway link – Kettering Road	760m	9.04
Supermarket – Fox Street	Harrington Road – Fox Street	780m	9.28
Newsagent – Harrington Road	Harrington Road	620m	7.38
High Street (Retail)	Harrington Road – Fox Street – Sun Hill - High Street	880m	10.47
Bridge Street (Retail/Doctors/Dentist)	Harrington Road – Fox Street – Sun Hill - High Street – Bridge Street	1km	12
Rothwell Victoria Infant School	Harrington Road – Fox Street – Sun Hill - High Street – Bridge Street – School Lane	1.1km	13
Rothwell Junior School	Harrington Road – Fox Street – Sun Hill – High Street - Bridge Street – Castle Hill – Gladstone Street	1.4km	17
Montsaye Community College (Secondary School)	Harrington Road – High Hill Avenue – Greening Road	1km	12

Walking Distance/Times to Local Services

As the previous table shows, the majority of facilities are within an acceptable walking distance from the application site. With regard to bus stops, Department for Transport guidance requires residential dwellings to be no more than 400m from a bus stop, whilst Northamptonshire County Councils 'Design Guide for Residential Roads' (November 2003) states that residential dwellings should be located no more than 300m from a bus stop. As the table shows, the maximum distance from the farthest point within the site is 350m, however the majority of the site will be within 300m of the bus stops.

Land North of A14, Rothwell

Trustees of Mrs J Thompson (Deceased)

As the previous table shows the application site is within walking distance to a range of important facilities. Journeys to the facilities in Rothwell from the site can be broken down into three routes which are:-

- Harrington Road - High Hill Avenue - Greening Road
- Harrington Road - Fox Street - Sun Hill - High Street - Bridge Street
- Edinburgh Close - Meadow Road - Kettering Road

Harrington Road, High Hill Avenue and Greening Road are used to access Montsaye Community College. High Hill Avenue and Greening Road both have wide footways on both sides and the carriageway has traffic calming in the form of speed humps that are located along the length of the road to its junction with Desborough Road, to the north.



Greening Road School Access

Harrington Road, Fox Street, Sun Hill, High Street and Bridge Street form the primary route to access newsagents, a small supermarket, doctors/dentist surgery's and the main retail area in Rothwell. The route has continuous footways with street lighting to each destination. Pedestrian crossings are located on Sun Hill, the High Street and Bridge Street allowing for a continuous safe passage. From Bridge Street, Victoria Infants and Rothwell Junior Schools can be accessed via School Lane, Castle Hill and Gladstone Road.

Land North of A14, Rothwell

Trustees of Mrs J Thompson (Deceased)



Fox Street/Sun Hill Supermarket



Crossing at Junction of Sun Hill and High Street



Bridge Street Pedestrian Crossing

Land North of A14, Rothwell

Trustees of Mrs J Thompson (Deceased)

As previously described the public right of way through the southern part of the site can be used as a direct link to Kettering Road, where bus stops offering a high frequency of services can be accessed. The public right of way is currently unmade and it is considered that it would be more attractive if upgraded to a sufficient footway/cycleway. Edinburgh Close and Meadow Road both have good footways and street lighting along their entire length until they meet with the southern end of Evison Road. Beyond this there is a 60m long public footpath linking directly with Kettering Road and the bus stops, which has scope to be upgraded to a shared footway/cycleway.

Drop kerbs are provided at most junctions on the previously discussed walking routes although there is a lack of tactile paving.

Cycling

There are currently no designated cycle networks within or in close proximity to Rothwell. A section of Cycle Network Route 53 is proposed approximately 800m south of the application site which can potentially be accessed from Loddington Road at the A14/A6 Roundabout.

The upgrading of the public right of way through the south of the site, the existing footway link to Kettering Road and the proposed vehicular access would offer good cycle links to the wider road network.

Accessibility to Further Services

Rothwell has Doctors/Dentist facilities on Bridge Street but no Hospital. The closest Hospital to Rothwell is Kettering General Hospital which is located approximately 5km east of the application site. Bus service 19 stops directly outside the hospital access.

Further schools are located in the neighbouring towns of Kettering, Market Harborough and Desborough and can be accessed by the bus services detailed previously in this report.

There is land to the north of Rothwell that is currently allocated for mixed use development, some of which will include employment. This will create further opportunities for future residents and allow employment facilities to be more accessible from Rothwell, and in particular the application site.

Conclusion

In summary, the site is located within acceptable distances of a range of essential and non-essential services such as schools, retail, health facilities and supermarkets although some improvements to footways/cycleways would increase the attractiveness and safety of the routes. The site also benefits from regular bus services offering connections with the wider network including a link with Kettering Rail Station, which are able to be used for commuting.

Land North of A14, Rothwell

Trustees of Mrs J Thompson (Deceased)

There is scope to improve the frequency of the 18 bus service with regard to weekday evening, Sunday and Bank Holiday services, and also the infrastructure at the Harrington Road bus stops.

Land North of A14, Rothwell

FIGURE 1

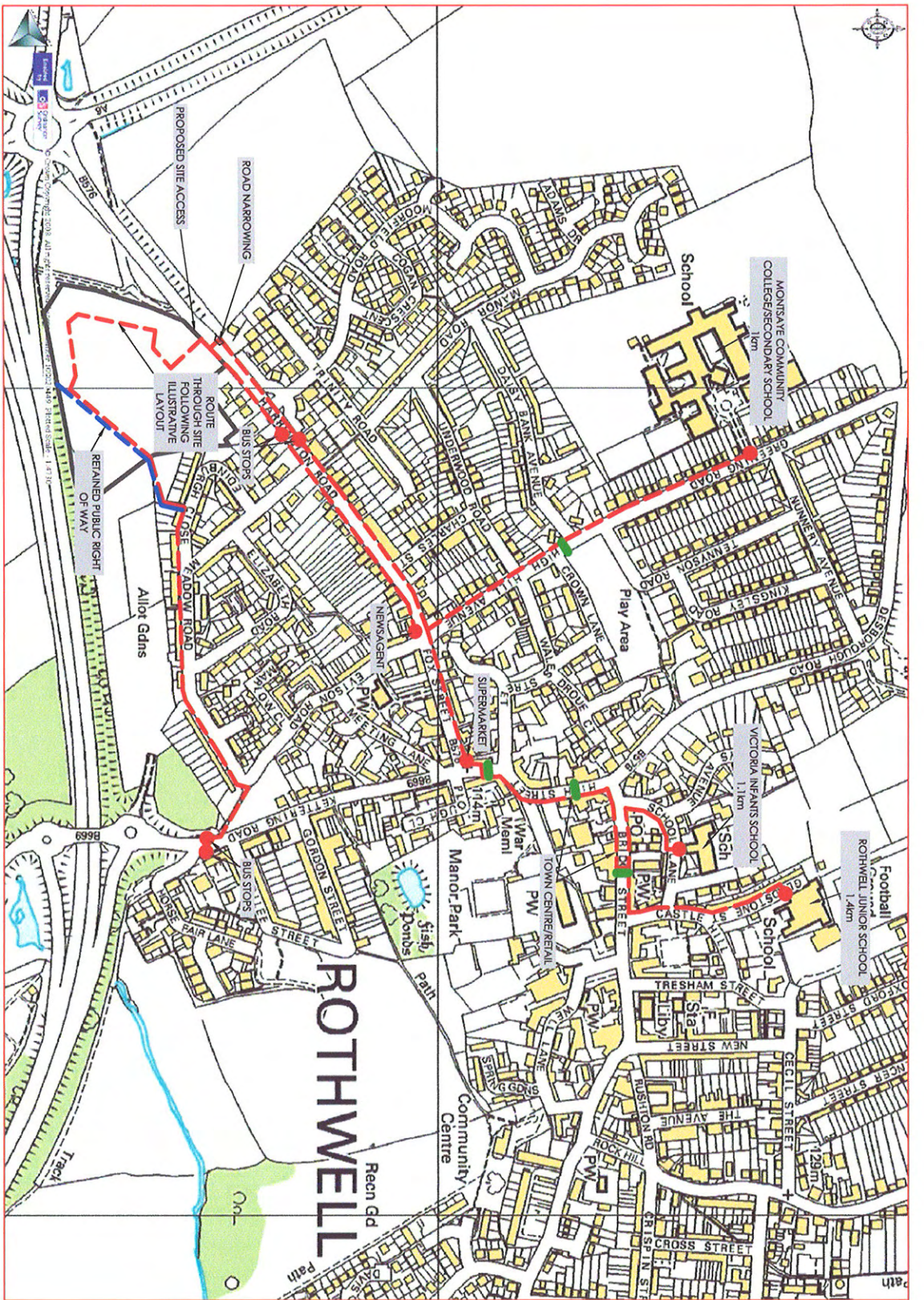

- KEY**
- - - WALKING ROUTE
 - PEDESTRIAN CROSSING
 - PUBLIC RIGHT OF WAY

Based upon the Ordnance Survey Map with the permission of the controller of H.M. Stationery Office © Crown Copyright Licence No. 100043330

© Copyright reserved

Client
TRUSTEES OF MRS. J. THOMPSON (DECEASED)

Scale 1:5000
 Sheet 550
 Format A3
 Sporn on Original

Project
LAND NORTH OF A14, ROTHWELL

The
PLAN OF LOCAL WALKING ROUTES

dip Transportation

52A HIGH STREET, NOTTINGHAM
 TEL: 01530 410380
 FAX: 01530 410380
 www.diptransportation.co.uk
 Also at: Borough Council, Nottingham & Sherwood

Project No. NI57-1T
 Issue No. 01
 Issue Date 01

APPENDIX A



Help

Route Timetables

Change Request Print

Date: Monday 10 November to Friday 14 November

18 Kettering - Rothwell - Deasborough - Market Harborough

Notes	Operators							
	SUC	SUC	SUC	SUC	SUC	SUC	SUC	SUC
Service Number	18	18	18	18	18	18	18	18
Kettering: Library Stop 11 Dep	0635	0750	0850	0950	1050	1150	1250	1350
Kettering: Newland St Stop 2	0640	0755	0855	0955	1055	1155	1255	1355
Kettering: Rockingham Rd o/s Sainsburys	0640	0755	0855	0955	1055	1155	1255	1355
Kettering: Rockingham Rd Hall's Garage	0642	0757	0857	0957	1057	1157	1257	1357
Kettering: Rockingham Rd o/s Satra House	0643	0758	0858	0958	1058	1158	1258	1358
Kettering: Rockingham Rd Furnace Lane	0643	0758	0858	0958	1058	1158	1258	1358
Kettering: Rockingham Rd opp Rockingham Paddocks	0644	0759	0859	0959	1059	1159	1259	1359
Kettering North Business Park Rockingham Rd Nort	0645	0800	0900	1000	1100	1200	1300	1400
Giandon: Rushton Rd o/s Lodge Cottage	0647	0802	0902	1002	1102	1202	1302	1402
Giandon Hall: Rushton Rd / o/s Hall	0648	0803	0903	1003	1103	1203	1303	1403
Rothwell: Kilton Field Drain Close	0653	0808	0908	1008	1108	1208	1308	1408
Rothwell: Columbus Cres opp Cook Cl	0655	0810	0910	1010	1110	1210	1310	1410
Rothwell: Market Hill Market House	0657	0812	0912	1012	1112	1212	1312	1412
Rothwell: High Street War Memorial	0658	0813	0913	1013	1113	1213	1313	1413
Rothwell: Harrington Rd opp Moorfield Rd	0700	0815	0915	1015	1115	1215	1315	1415
Rothwell: Manor Rd Underwood Rd	0703	0818	0918	1018	1118	1218	1318	1418
Rothwell: Greening Rd Daisy Bank Ave	0703	0818	0918	1018	1118	1218	1318	1418
Deasborough: Rothwell Rd Pioneer Ave	0707	0822	0922	1022	1122	1222	1322	1422
Deasborough: High St Chip Shop	--	0824	0924	1024	1124	1224	1324	1424
Deasborough: Dunkirk Ave Paddock La	--	0824	0924	1024	1124	1224	1324	1424
Deasborough: Dunkirk Ave opp Breakkeys Rd	--	0825	0925	1025	1125	1225	1325	1425
Deasborough: Isle Vale Ave Dunkirk Ave	--	0825	0925	1025	1125	1225	1325	1425
Deasborough: Isle Vale Ave Broadlands	--	0825	0925	1025	1125	1225	1325	1425
Deasborough: Broadlands Chestnut Drive	--	0826	0926	1026	1126	1226	1326	1426
Deasborough: Broadlands opp Radwood Cl	--	0826	0926	1026	1126	1226	1326	1426
Deasborough: Rushton Rd opp the Cemetery	--	0827	0927	1027	1127	1227	1327	1427
Deasborough: Rushton Rd Mayfield Rd	--	0828	0928	1028	1128	1228	1328	1428
Deasborough: Rushton Rd Union St	--	0829	0929	1029	1129	1229	1329	1429
Deasborough: Station Rd Queen St	--	0830	0930	1030	1130	1230	1330	1430
Deasborough: High St o/s Library	0709	--	--	--	--	--	--	--
Deasborough: Gold St Harrington Rd	0711	0833	0933	1033	1133	1233	1333	1433
Deasborough: Braybrooke Rd opp Hilltop	0714	0835	0935	1035	1135	1235	1335	1435
Deasborough: Braybrooke Rd opp Ash Grove	0714	0835	0935	1035	1135	1235	1335	1435
Braybrooke: Deasborough Rd The Green	0718	0839	0939	1039	1139	1239	1339	1439
Braybrooke: Harborough Rd Church Cl	0718	0839	0939	1039	1139	1239	1339	1439
Market Harborough: Braybrooke Rd (Queen St)	0722	0843	0943	1043	1143	1243	1343	1443
Market Harborough: Scotland Rd (Havenburgh Eng)	0722	0843	0943	1043	1143	1243	1343	1443
Market Harborough: Northampton Road (Gladstone)	0723	0844	0944	1044	1144	1244	1344	1444
Market Harborough: Northampton Rd (Brooklands)	0723	0844	0944	1044	1144	1244	1344	1444
Market Harborough: Market Hall (Northampton Rd)	0724	0845	0945	1045	1145	1245	1345	1445
Market Harborough: Northampton Rd (Patrick St)	--	0846	0946	1046	1146	1246	1346	1446
Market Harborough: Bath Street (Courtyard Works)	--	0848	0948	1048	1148	1248	1348	1448
Market Harborough: Fairfax Road (Ireton Road)	--	0849	0949	1049	1149	1249	1349	1449
Market Harborough: Stuart Road (Fairfax Road)	--	0849	0949	1049	1149	1249	1349	1449
Market Harborough: Stuart Road (Skippon Close)	--	0850	0950	1050	1150	1250	1350	1450
Market Harborough: Cromwell Crescent (Essex Gar	--	0852	0952	1052	1152	1252	1352	1452
Market Harborough: Cromwell Cresc (Rochester Gd	--	0853	0953	1053	1153	1253	1353	1453
Market Harborough: Cromwell Cresc (Rowan Av)	--	0853	0953	1053	1153	1253	1353	1453
Market Harborough: Fairfax Road (Western Avenue)	--	0854	0954	1054	1154	1254	1354	1454
Market Harborough: Bath Street (Fairfax Road)	--	0855	0955	1055	1155	1255	1355	1455
Market Harborough: Lathkill Street (Bath Street)	--	0856	0956	1056	1156	1256	1356	1456
Market Harborough: Lathkill Street (New Dev)	--	0856	0956	1056	1156	1256	1356	1456
Market Harborough: Northampton Road (Gladstone)	--	0858	0958	1058	1158	1258	1358	1458
Market Harborough: Market Hall (Northampton Rd) Arr	--	0900	1000	1100	1200	1300	1400	1500
Market Harborough: Rockingham Rd (Rail Str) Arr	0728	--	--	--	--	--	--	--

Key: Firm Emes shown as: 1200 Estimated Emes shown as: 1200

Notes	Operators			
	SUC	SUC	SUC	SUC
Service Number	18	18	18	18
Kettering: Library Stop 11 Dep	1450	1550	1650	1750
Kettering: Newland St Stop 2	1455	1555	1655	1755
Kettering: Rockingham Rd o/s Sainsburys	1455	1555	1655	1755
Kettering: Rockingham Rd Hall's Garage	1457	1557	1657	1757
Kettering: Rockingham Rd o/s Satra House	1458	1558	1658	1758
Kettering: Rockingham Rd Furnace Lane	1458	1558	1658	1758
Kettering: Rockingham Rd opp Rockingham Paddocks	1459	1559	1659	1759
Kettering North Business Park Rockingham Rd Nort	1500	1600	1700	1800
Giandon: Rushton Rd o/s Lodge Cottage	1502	1602	1702	1802
Giandon Hall: Rushton Rd / o/s Hall	1503	1603	1703	1803
Rothwell: Kilton Field Drain Close	1508	1608	1708	1808
Rothwell: Columbus Cres opp Cook Cl	1510	1610	1710	1810
Rothwell: Market Hill Market House	1512	1612	1712	1812
Rothwell: High Street War Memorial	1513	1613	1713	1813
Rothwell: Harrington Rd opp Moorfield Rd	1515	1615	1715	1815
Rothwell: Manor Rd Underwood Rd	1518	1618	1718	1818
Rothwell: Greening Rd Daisy Bank Ave	1518	1618	1718	1818
Deasborough: Rothwell Rd Pioneer Ave	1522	1622	1722	1822
Deasborough: High St Chip Shop	1524	1624	1724	1824
Deasborough: Dunkirk Ave Paddock La	1524	1624	1724	1824
Deasborough: Dunkirk Ave opp Breakkeys Rd	1525	1625	1725	1825
Deasborough: Isle Vale Ave Dunkirk Ave	1525	1625	1725	1825
Deasborough: Isle Vale Ave Broadlands	1525	1625	1725	1825
Deasborough: Broadlands Chestnut Drive	1526	1626	1726	1826
Deasborough: Broadlands opp Radwood Cl	1526	1626	1726	1826
Deasborough: Rushton Rd opp the Cemetery	1527	1627	1727	1827
Deasborough: Rushton Rd Mayfield Rd	1528	1628	1728	1828
Deasborough: Rushton Rd Union St	1529	1629	1729	1829
Deasborough: Station Rd Queen St	1530	1630	1730	1830
Deasborough: High St o/s Library	--	--	--	--
Deasborough: Gold St Harrington Rd	1533	1633	1733	1833
Deasborough: Braybrooke Rd opp Hilltop	1535	1635	1735	1835
Deasborough: Braybrooke Rd opp Ash Grove	1535	1635	1735	1835
Braybrooke: Deasborough Rd The Green	1539	1639	1739	1839
Braybrooke: Harborough Rd Church Cl	1539	1639	1739	1839
Market Harborough: Braybrooke Rd (Queen St)	1543	1643	1743	1843
Market Harborough: Scotland Rd (Havenburgh Eng)	1543	1643	1743	1843
Market Harborough: Northampton Road (Gladstone)	1544	1644	1744	1844
Market Harborough: Northampton Rd (Brooklands)	1544	1644	1744	1844
Market Harborough: Market Hall (Northampton Rd)	1545	1645	1745	1845
Market Harborough: Northampton Rd (Patrick St)	1546	1646	--	--
Market Harborough: Bath Street (Courtyard Works)	1548	1648	--	--
Market Harborough: Fairfax Road (Ireton Road)	1549	1649	--	--
Market Harborough: Stuart Road (Fairfax Road)	1549	1649	--	--
Market Harborough: Stuart Road (Skippon Close)	1550	1650	--	--
Market Harborough: Cromwell Crescent (Essex Gar	1552	1652	--	--
Market Harborough: Cromwell Cresc (Rochester Gd	1553	1653	--	--
Market Harborough: Cromwell Cresc (Rowan Av)	1553	1653	--	--
Market Harborough: Fairfax Road (Western Avenue)	1554	1654	--	--
Market Harborough: Bath Street (Fairfax Road)	1555	1655	--	--
Market Harborough: Lathkill Street (Bath Street)	1556	1656	--	--
Market Harborough: Lathkill Street (New Dev)	1556	1656	--	--
Market Harborough: Northampton Road (Gladstone)	1558	1658	--	--
Market Harborough: Market Hall (Northampton Rd) Arr	1600	1700	--	--
Market Harborough: Rockingham Rd (Rail Str) Arr	--	--	1749	1849

Key: Firm Emes shown as: 1200 Estimated Emes shown as: 1200

Notes

SUC - Stagecoach



Help

Route Timetables

[Change Request](#) [Print](#)

Date: Monday 10 November to Friday 14 November

18 Market Harborough - Desborough - Rothwell - Kettering

Notes	Operators							
	SUC	SUC	SUC	SUC	SUC	SUC	SUC	SUC
Service Number	18	18	18	18	18	18	18	18
Market Harborough: Rockingham Rd (Rail Stn) Dep:	--	--	--	--	--	--	--	--
Market Harborough: St Mary's Rd (Kettering Rd)	--	--	--	--	--	--	--	--
Market Harborough: Market Hall (Northampton Rd)	0745	0905	1005	1105	1205	1305	1405	1505
Market Harborough: Northampton Rd (Patrick St)	0745	0905	1005	1105	1205	1305	1405	1505
Market Harborough: Northampton Rd (Braybrooke R)	0745	0905	1005	1105	1205	1305	1405	1505
Market Harborough: Scotland Road	0746	0906	1006	1106	1206	1306	1406	1506
Market Harborough: Braybrooke Road	0746	0906	1006	1106	1206	1306	1406	1506
Braybrooke: Harborough Rd opp No21	0750	0910	1010	1110	1210	1310	1410	1510
Braybrooke: Desborough Rd opp School La	0751	0911	1011	1111	1211	1311	1411	1511
Desborough: Braybrooke Rd Ash Grove	0754	0914	1014	1114	1214	1314	1414	1514
Desborough: Braybrooke Rd Sports Ground	0755	0915	1015	1115	1215	1315	1415	1515
Desborough: Gold Street opp Harrington Rd	0758	0916	1016	1116	1216	1316	1416	1516
Desborough: High St Chip Shop	0801	0917	1017	1117	1217	1317	1417	1517
Desborough: Dunkirk Ave Paddock La	--	0917	1017	1117	1217	1317	1417	1517
Desborough: Dunkirk Ave opp Breakleys Rd	--	0918	1018	1118	1218	1318	1418	1518
Desborough: Ise Vale Ave Dunkirk Ave	--	0919	1019	1119	1219	1319	1419	1519
Desborough: Ise Vale Ave Broadlands	--	0919	1019	1119	1219	1319	1419	1519
Desborough: Broadlands Chestnut Drive	--	0920	1020	1120	1220	1320	1420	1520
Desborough: Broadlands opp Redwood Cl	--	0920	1020	1120	1220	1320	1420	1520
Desborough: Rushton Rd opp the Cemetery	--	0921	1021	1121	1221	1321	1421	1521
Desborough: Rushton Rd Mayfield Rd	--	0921	1021	1121	1221	1321	1421	1521
Desborough: Rushton Rd Union St	--	0922	1022	1122	1222	1322	1422	1522
Desborough: Station Rd Queen St	--	0923	1023	1123	1223	1323	1423	1523
Desborough: High St Chip Shop	--	0926	1026	1126	1226	1326	1426	1526
Desborough: Lower St Church	0801	0926	1026	1126	1226	1326	1426	1526
Desborough: St Anthony's Hill opp Federation Av	0802	0927	1027	1127	1227	1327	1427	1527
Desborough: Rothwell Rd opp Pioneer Ave	0802	0927	1027	1127	1227	1327	1427	1527
Rothwell: Greening Rd / opp Montsaye Sch	0805	0930	1030	1130	1230	1330	1430	1530
Rothwell: Greening Rd opp Daisy Bank Ave	0806	0931	1031	1131	1231	1331	1431	1531
Rothwell: Manor Rd opp Underwood Rd	0807	0932	1032	1132	1232	1332	1432	1532
Rothwell: Harrington Rd Moorfield Rd	0809	0934	1034	1134	1234	1334	1434	1534
Rothwell: Bridge Street opp Market Hill	0812	0937	1037	1137	1237	1337	1437	1537
Rothwell: Columbus Cres Cook Cl	0814	0939	1039	1139	1239	1339	1439	1539
Rothwell: Kipton Field opp Drake Close	0817	0942	1042	1142	1242	1342	1442	1542
Glendon Hall: Rushton Rd / opp Hall	0821	0946	1046	1146	1246	1346	1446	1546
Glendon: Rushton Rd / opp Lodge Cottage	0822	0947	1047	1147	1247	1347	1447	1547
Kettering North Business Park Rockingham Road So	0825	0950	1050	1150	1250	1350	1450	1550
Kettering: Rockingham Rd Rockingham Paddocks	0826	0951	1051	1151	1251	1351	1451	1551
Kettering: Rockingham Rd o/s The Beeswing PH	0827	0952	1052	1152	1252	1352	1452	1552
Kettering: Rockingham Rd Kingsley Ave	0828	0953	1053	1153	1253	1353	1453	1553
Kettering: Rockingham Rd Athletic Club	0830	0955	1055	1155	1255	1355	1455	1555
Kettering: Rockingham Rd Regent St	0832	0957	1057	1157	1257	1357	1457	1557
Kettering: Eskdall St Stop 6	0835	1000	1100	1200	1300	1400	1500	1600
Kettering: Victoria St opp School La	0836	1001	1101	1201	1301	1401	1501	1601
Kettering: Library Stop 11 Arr:	0840	1005	1105	1205	1305	1405	1505	1605

Key: Firm times shown as: 1200 Estimated times shown as: 1200

Notes	Operators			
	SUC	SUC	SUC	SUC
Service Number	18	18	18	18
Market Harborough: Rockingham Rd (Rail Stn) Dep:	--	--	1810	1910
Market Harborough: Market Hall (Northampton Rd)	1605	1705	1815	1915
Market Harborough: Northampton Rd (Patrick St)	1605	1705	1815	1915
Market Harborough: Northampton Rd (Braybrooke R)	1605	1705	1815	1915
Market Harborough: Scotland Road	1606	1706	1816	1916
Market Harborough: Braybrooke Road	1606	1706	1816	1916
Braybrooke: Harborough Rd opp No21	1610	1710	1820	1920
Braybrooke: Desborough Rd opp School La	1611	1711	1821	1921
Desborough: Braybrooke Rd Ash Grove	1614	1714	1824	1924
Desborough: Braybrooke Rd Sports Ground	1615	1715	1825	1925
Desborough: Gold Street opp Harrington Rd	1616	1716	1826	1926
Desborough: High St Chip Shop	1617	1717	1827	1927
Desborough: Dunkirk Ave Paddock La	1617	1717	1827	1927
Desborough: Dunkirk Ave opp Breakleys Rd	1618	1718	1828	1928
Desborough: Ise Vale Ave Dunkirk Ave	1619	1719	1829	1929
Desborough: Ise Vale Ave Broadlands	1619	1719	1829	1929
Desborough: Broadlands Chestnut Drive	1620	1720	1830	1930
Desborough: Broadlands opp Redwood Cl	1620	1720	1830	1930
Desborough: Rushton Rd opp the Cemetery	1621	1721	1831	1931
Desborough: Rushton Rd Mayfield Rd	1621	1721	1831	1931
Desborough: Rushton Rd Union St	1622	1722	1832	1932
Desborough: Station Rd Queen St	1623	1723	1833	1933
Desborough: High St Chip Shop	1626	1726	1836	1936
Desborough: Lower St Church	1626	1726	1836	1936
Desborough: St Anthony's Hill opp Federation Av	1627	1727	1837	1937
Desborough: Rothwell Rd opp Pioneer Ave	1627	1727	1837	1937
Rothwell: Greening Rd / opp Montsaye Sch	1630	1730	1840	1940
Rothwell: Greening Rd opp Daisy Bank Ave	1631	1731	1841	1941
Rothwell: Manor Rd opp Underwood Rd	1632	1732	1842	1942
Rothwell: Harrington Rd Moorfield Rd	1634	1734	1844	1944
Rothwell: Bridge Street opp Market Hill	1637	1737	1847	1947
Rothwell: Columbus Cres Cook Cl	1639	1739	1849	1949
Rothwell: Kipton Field opp Drake Close	1642	1742	1852	1952
Glendon Hall: Rushton Rd / opp Hall	1646	1746	1856	1956
Glendon: Rushton Rd / opp Lodge Cottage	1647	1747	1857	1957
Kettering North Business Park Rockingham Road So	1650	1750	1900	2000
Kettering: Rockingham Rd Rockingham Paddocks	1651	1751	1901	2001
Kettering: Rockingham Rd o/s The Beeswing PH	1652	1752	1902	2002
Kettering: Rockingham Rd Kingsley Ave	1653	1753	1903	2003
Kettering: Rockingham Rd Athletic Club	1655	1755	1905	2005
Kettering: Rockingham Rd Regent St	1657	1757	1907	2007
Kettering: Eskdall St Stop 6	1700	1800	1910	2010
Kettering: Victoria St opp School La	1701	1801	1911	2011
Kettering: Library Stop 11 Arr:	1705	1805	1915	2015

Key: Firm times shown as: 1200 Estimated times shown as: 1200

Notes:

SUC = Stagecoach

[Change Request](#) [Print](#)

Results compiled from a timetable database built on 08/11/2008 07:00:08



Help

Route Timetables

[Change Request](#) [Print](#)

Date: Saturday 15 November

18 Kettering - Rothwell - Desborough - Market Harborough

Notes	Operators							
	SUC	SUC	SUC	SUC	SUC	SUC	SUC	SUC
Service Number	18	18	18	18	18	18	18	18
Kettering Library Stop 11 Dep	0635	0750	0850	0950	1050	1150	1250	1350
Kettering Newland St Stop 2	0640	0755	0855	0955	1055	1155	1255	1355
Kettering Rockingham Rd o/s Sainsburys	0640	0755	0855	0955	1055	1155	1255	1355
Kettering Rockingham Rd Halls Garage	0642	0757	0857	0957	1057	1157	1257	1357
Kettering Rockingham Rd o/s Safra House	0643	0758	0858	0958	1058	1158	1258	1358
Kettering Rockingham Rd Furnace Lane	0643	0758	0858	0958	1058	1158	1258	1358
Kettering Rockingham Rd opp Rockingham Paddocks	0644	0759	0859	0959	1059	1159	1259	1359
Kettering North Business Park Rockingham Rd Nort	0645	0800	0900	1000	1100	1200	1300	1400
Giandon Rushton Rd o/s Lodge Cottage	0647	0802	0902	1002	1102	1202	1302	1402
Giandon Hall Rushton Rd / o/s Hall	0648	0803	0903	1003	1103	1203	1303	1403
Rothwell Kipton Field Drake Close	0653	0808	0908	1008	1108	1208	1308	1408
Rothwell Columbus Cres opp Cook Cl	0655	0810	0910	1010	1110	1210	1310	1410
Rothwell Market Hill Market House	0657	0812	0912	1012	1112	1212	1312	1412
Rothwell High Street War Memorial	0658	0813	0913	1013	1113	1213	1313	1413
Rothwell Harrington Rd opp Moorfield Rd	0700	0815	0915	1015	1115	1215	1315	1415
Rothwell Manor Rd Underwood Rd	0703	0818	0918	1018	1118	1218	1318	1418
Rothwell Greening Rd Daisy Bank Ave	0703	0818	0918	1018	1118	1218	1318	1418
Desborough Rothwell Rd Pioneer Ave	0707	0822	0922	1022	1122	1222	1322	1422
Desborough High St Chip Shop	--	0824	0924	1024	1124	1224	1324	1424
Desborough Dunkirk Ave Paddock La	--	0824	0924	1024	1124	1224	1324	1424
Desborough Dunkirk Ave opp Breakkeys Rd	--	0825	0925	1025	1125	1225	1325	1425
Desborough Isle Vale Ave Dunkirk Ave	--	0825	0925	1025	1125	1225	1325	1425
Desborough Isle Vale Ave Broadlands	--	0825	0925	1025	1125	1225	1325	1425
Desborough Broadlands Chestnut Drive	--	0826	0926	1026	1126	1226	1326	1426
Desborough Broadlands opp Redwood Cl	--	0826	0926	1026	1126	1226	1326	1426
Desborough Rushton Rd opp the Cemetery	--	0827	0927	1027	1127	1227	1327	1427
Desborough Rushton Rd Mayfield Rd	--	0828	0928	1028	1128	1228	1328	1428
Desborough Rushton Rd Union St	--	0829	0929	1029	1129	1229	1329	1429
Desborough Station Rd Queen St	--	0830	0930	1030	1130	1230	1330	1430
Desborough High St o/s Library	0709	--	--	--	--	--	--	--
Desborough Gold St Harrington Rd	0711	0833	0933	1033	1133	1233	1333	1433
Desborough Braybrooke Rd opp Hilltop	0714	0835	0935	1035	1135	1235	1335	1435
Desborough Braybrooke Rd opp Ash Grove	0714	0835	0935	1035	1135	1235	1335	1435
Braybrooke Desborough Rd The Green	0718	0839	0939	1039	1139	1239	1339	1439
Braybrooke Harborough Rd Church Cl	0718	0839	0939	1039	1139	1239	1339	1439
Market Harborough Braybrooke Rd (Queen St)	0723	0843	0943	1043	1143	1243	1343	1443
Market Harborough Sootland Rd (Havenburgh Eng)	0723	0843	0943	1043	1143	1243	1343	1443
Market Harborough Northampton Road (Gladstone)	0724	0844	0944	1044	1144	1244	1344	1444
Market Harborough Northampton Rd (Brooklands)	0724	0844	0944	1044	1144	1244	1344	1444
Market Harborough Market Hill (Northampton Rd)	0725	0845	0945	1045	1145	1245	1345	1445
Market Harborough Northampton Rd (Patrick St)	0726	0846	0946	1046	1146	1246	1346	1446
Market Harborough Bath Street (Courtyard Works)	0728	0848	0948	1048	1148	1248	1348	1448
Market Harborough Fairfax Road (refon Road)	0729	0849	0949	1049	1149	1249	1349	1449
Market Harborough Stuart Road (Fairfax Road)	0729	0849	0949	1049	1149	1249	1349	1449
Market Harborough Stuart Road (Skippon Close)	0730	0850	0950	1050	1150	1250	1350	1450
Market Harborough Cromwell Crescent (Essex Gar	0732	0852	0952	1052	1152	1252	1352	1452
Market Harborough Cromwell Cres (Rochester Gd	0733	0853	0953	1053	1153	1253	1353	1453
Market Harborough Cromwell Cres (Rowan Av)	0733	0853	0953	1053	1153	1253	1353	1453
Market Harborough Fairfax Road (Western Avenue	0734	0854	0954	1054	1154	1254	1354	1454
Market Harborough Bath Street (Fairfax Road)	0735	0855	0955	1055	1155	1255	1355	1455
Market Harborough Lathkill Street (Bath Street	0736	0856	0956	1056	1156	1256	1356	1456
Market Harborough Lathkill Street (New Dev)	0736	0856	0956	1056	1156	1256	1356	1456
Market Harborough Northampton Road (Gladstone	0738	0858	0958	1058	1158	1258	1358	1458
Market Harborough Market Hill (Northampton Rd) Arr	0740	0900	1000	1100	1200	1300	1400	1500

Key: Firm Times shown as: 1200 Estimated Times shown as: 1200

Notes	Operators			
	SUC	SUC	SUC	SUC
Service Number	18	18	18	18
Kettering Library Stop 11 Dep	1450	1550	1650	1750
Kettering Newland St Stop 2	1455	1555	1655	1755
Kettering Rockingham Rd o/s Sainsburys	1455	1555	1655	1755
Kettering Rockingham Rd Halls Garage	1457	1557	1657	1757
Kettering Rockingham Rd o/s Safra House	1458	1558	1658	1758
Kettering Rockingham Rd Furnace Lane	1458	1558	1658	1758
Kettering Rockingham Rd opp Rockingham Paddocks	1459	1559	1659	1759
Kettering North Business Park Rockingham Rd Nort	1500	1600	1700	1800
Giandon Rushton Rd o/s Lodge Cottage	1502	1602	1702	1802
Giandon Hall Rushton Rd / o/s Hall	1502	1602	1702	1802
Rothwell Kipton Field Drake Close	1508	1608	1708	1808
Rothwell Columbus Cres opp Cook Cl	1510	1610	1710	1810
Rothwell Market Hill Market House	1512	1612	1712	1812
Rothwell High Street War Memorial	1513	1613	1713	1813
Rothwell Harrington Rd opp Moorfield Rd	1515	1615	1715	1815
Rothwell Manor Rd Underwood Rd	1518	1618	1718	1818
Rothwell Greening Rd Daisy Bank Ave	1518	1618	1718	1818
Desborough Rothwell Rd Pioneer Ave	1522	1622	1722	1822
Desborough High St Chip Shop	1524	1624	1724	1824
Desborough Dunkirk Ave Paddock La	1524	1624	1724	1824
Desborough Dunkirk Ave opp Breakkeys Rd	1525	1625	1725	1825
Desborough Isle Vale Ave Dunkirk Ave	1525	1625	1725	1825
Desborough Isle Vale Ave Broadlands	1525	1625	1725	1825
Desborough Broadlands Chestnut Drive	1526	1626	1726	1826
Desborough Broadlands opp Redwood Cl	1526	1626	1726	1826
Desborough Rushton Rd opp the Cemetery	1527	1627	1727	1827
Desborough Rushton Rd Mayfield Rd	1528	1628	1728	1828
Desborough Rushton Rd Union St	1529	1629	1729	1829
Desborough Station Rd Queen St	1530	1630	1730	1830
Desborough High St o/s Library	--	--	--	--
Desborough Gold St Harrington Rd	1533	1633	1733	1833
Desborough Braybrooke Rd opp Hilltop	1535	1635	1735	1835
Desborough Braybrooke Rd opp Ash Grove	1535	1635	1735	1835
Braybrooke Desborough Rd The Green	1539	1639	1739	1839
Braybrooke Harborough Rd Church Cl	1539	1639	1739	1839
Market Harborough Braybrooke Rd (Queen St)	1543	1643	1743	1843
Market Harborough Sootland Rd (Havenburgh Eng)	1543	1643	1743	1843
Market Harborough Northampton Road (Gladstone)	1544	1644	1744	1844
Market Harborough Northampton Rd (Brooklands)	1544	1644	1744	1844
Market Harborough Market Hill (Northampton Rd)	1545	1645	1745	1845
Market Harborough Northampton Rd (Patrick St)	1546	1646	1746	1846
Market Harborough Bath Street (Courtyard Works)	1548	1648	1748	1848
Market Harborough Fairfax Road (refon Road)	1549	1649	1749	1849
Market Harborough Stuart Road (Fairfax Road)	1549	1649	1749	1849
Market Harborough Stuart Road (Skippon Close)	1550	1650	1750	1850
Market Harborough Cromwell Crescent (Essex Gar	1552	1652	1752	1852
Market Harborough Cromwell Cres (Rochester Gd	1553	1653	1753	1853
Market Harborough Cromwell Cres (Rowan Av)	1553	1653	1753	1853
Market Harborough Fairfax Road (Western Avenue	1554	1654	1754	1854
Market Harborough Bath Street (Fairfax Road)	1555	1655	1755	1855
Market Harborough Lathkill Street (Bath Street	1556	1656	1756	1856
Market Harborough Lathkill Street (New Dev)	1556	1656	1756	1856
Market Harborough Northampton Road (Gladstone	1558	1658	1758	1858
Market Harborough Market Hill (Northampton Rd) Arr	1600	1700	1800	1900

Key: Firm Times shown as: 1200 Estimated Times shown as: 1200

Notes:

SUC = Stagecoach

[Change Request](#) [Print](#)



Help

Route Timetables

[Change Request](#) [Print](#)

Date: Saturday 15 November

18 Market Harborough - Desborough - Rothwell - Kettering

Notes	SUC	SUC	SUC	SUC	SUC	SUC	SUC	SUC
Operators	18	18	18	18	18	18	18	18
Service Number	18	18	18	18	18	18	18	18
Market Harborough: Rockingham Rd (Rail Stn) Dep:	--	--	--	--	--	--	--	--
Market Harborough: Market Hall (Northampton Rd)	0745	0905	1005	1105	1205	1305	1405	1505
Market Harborough: Northampton Rd (Patrick St)	0745	0905	1005	1105	1205	1305	1405	1505
Market Harborough: Northampton Rd (Braybrooke R	0745	0905	1005	1105	1205	1305	1405	1505
Market Harborough: Scotland Road	0746	0906	1006	1106	1206	1306	1406	1506
Market Harborough: Braybrooke Road	0746	0906	1006	1106	1206	1306	1406	1506
Braybrooke: Harborough Rd opp No21	0750	0910	1010	1110	1210	1310	1410	1510
Braybrooke: Desborough Rd opp School La	0751	0911	1011	1111	1211	1311	1411	1511
Desborough: Braybrooke Rd Ash Grove	0754	0914	1014	1114	1214	1314	1414	1514
Desborough: Braybrooke Rd Sports Ground	0755	0915	1015	1115	1215	1315	1415	1515
Desborough: Gold Street opp Harrington Rd	0758	0916	1016	1116	1216	1316	1416	1516
Desborough: High St Chip Shop	0801	0917	1017	1117	1217	1317	1417	1517
Desborough: Dunkirk Ave Paddock La	--	0917	1017	1117	1217	1317	1417	1517
Desborough: Dunkirk Ave opp Breakleys Rd	--	0918	1018	1118	1218	1318	1418	1518
Desborough: Ise Vale Ave Dunkirk Ave	--	0919	1019	1119	1219	1319	1419	1519
Desborough: Ise Vale Ave Broadlands	--	0919	1019	1119	1219	1319	1419	1519
Desborough: Broadlands Chestnut Drive	--	0920	1020	1120	1220	1320	1420	1520
Desborough: Broadlands opp Redwood Cl	--	0920	1020	1120	1220	1320	1420	1520
Desborough: Rushton Rd opp the Cemetery	--	0921	1021	1121	1221	1321	1421	1521
Desborough: Rushton Rd Mayfield Rd	--	0921	1021	1121	1221	1321	1421	1521
Desborough: Rushton Rd Union St	--	0922	1022	1122	1222	1322	1422	1522
Desborough: Station Rd Queen St	--	0923	1023	1123	1223	1323	1423	1523
Desborough: High St Chip Shop	--	0926	1026	1126	1226	1326	1426	1526
Desborough: Lower St Church	0801	0926	1026	1126	1226	1326	1426	1526
Desborough: St Anthony's Hill opp Federation Av	0802	0927	1027	1127	1227	1327	1427	1527
Desborough: Rothwell Rd opp Pioneer Ave	0802	0927	1027	1127	1227	1327	1427	1527
Rothwell: Greening Rd / opp Montsaye Sch	0805	0930	1030	1130	1230	1330	1430	1530
Rothwell: Greening Rd opp Daisy Bank Ave	0806	0931	1031	1131	1231	1331	1431	1531
Rothwell: Manor Rd opp Underwood Rd	0807	0932	1032	1132	1232	1332	1432	1532
Rothwell: Harrington Rd Moorfield Rd	0809	0934	1034	1134	1234	1334	1434	1534
Rothwell: Bridge Street opp Market Hill	0812	0937	1037	1137	1237	1337	1437	1537
Rothwell: Columbus Cres Cook Cl	0814	0939	1039	1139	1239	1339	1439	1539
Rothwell: Kipton Field opp Drake Close	0817	0942	1042	1142	1242	1342	1442	1542
Glendon Hall: Rushton Rd / opp Hall	0821	0946	1046	1146	1246	1346	1446	1546
Glendon: Rushton Rd / opp Lodge Cottage	0822	0947	1047	1147	1247	1347	1447	1547
Kettering North Business Park Rockingham Road So	0825	0950	1050	1150	1250	1350	1450	1550
Kettering: Rockingham Rd Rockingham Paddocks	0826	0951	1051	1151	1251	1351	1451	1551
Kettering: Rockingham Rd o/s The Beeswing PH	0827	0952	1052	1152	1252	1352	1452	1552
Kettering: Rockingham Rd Kingsley Ave	0828	0953	1053	1153	1253	1353	1453	1553
Kettering: Rockingham Rd Athletic Club	0830	0955	1055	1155	1255	1355	1455	1555
Kettering: Rockingham Rd Regent St	0832	0957	1057	1157	1257	1357	1457	1557
Kettering: Eskdall St Stop 6	0835	1000	1100	1200	1300	1400	1500	1600
Kettering: Victoria St opp School La	0836	1001	1101	1201	1301	1401	1501	1601
Kettering: Library Stop 11 Arr:	0840	1005	1105	1205	1305	1405	1505	1605

Key: Firm times shown as: 1200 Estimated times shown as: 1200

Notes	SUC	SUC	SUC	SUC
Operators	18	18	18	18
Service Number	18	18	18	18
Market Harborough: Rockingham Rd (Rail Stn) Dep:	--	--	1810	1910
Market Harborough: Market Hall (Northampton Rd)	1605	1705	1815	1915
Market Harborough: Northampton Rd (Patrick St)	1605	1705	1815	1915
Market Harborough: Northampton Rd (Braybrooke R	1605	1705	1815	1915
Market Harborough: Scotland Road	1606	1706	1816	1916
Market Harborough: Braybrooke Road	1606	1706	1816	1916
Braybrooke: Harborough Rd opp No21	1610	1710	1820	1920
Braybrooke: Desborough Rd opp School La	1611	1711	1821	1921
Desborough: Braybrooke Rd Ash Grove	1614	1714	1824	1924
Desborough: Braybrooke Rd Sports Ground	1615	1715	1825	1925
Desborough: Gold Street opp Harrington Rd	1616	1716	1826	1926
Desborough: High St Chip Shop	1617	1717	1827	1927
Desborough: Dunkirk Ave Paddock La	1617	1717	1827	1927
Desborough: Dunkirk Ave opp Breakleys Rd	1618	1718	1828	1928
Desborough: Ise Vale Ave Dunkirk Ave	1619	1719	1829	1929
Desborough: Ise Vale Ave Broadlands	1619	1719	1829	1929
Desborough: Broadlands Chestnut Drive	1620	1720	1830	1930
Desborough: Broadlands opp Redwood Cl	1620	1720	1830	1930
Desborough: Rushton Rd opp the Cemetery	1621	1721	1831	1931
Desborough: Rushton Rd Mayfield Rd	1621	1721	1831	1931
Desborough: Rushton Rd Union St	1622	1722	1832	1932
Desborough: Station Rd Queen St	1623	1723	1833	1933
Desborough: High St Chip Shop	1626	1726	1836	1936
Desborough: Lower St Church	1626	1726	1836	1936
Desborough: St Anthony's Hill opp Federation Av	1627	1727	1837	1937
Desborough: Rothwell Rd opp Pioneer Ave	1627	1727	1837	1937
Rothwell: Greening Rd / opp Montsaye Sch	1630	1730	1840	1940
Rothwell: Greening Rd opp Daisy Bank Ave	1631	1731	1841	1941
Rothwell: Manor Rd opp Underwood Rd	1632	1732	1842	1942
Rothwell: Harrington Rd Moorfield Rd	1634	1734	1844	1944
Rothwell: Bridge Street opp Market Hill	1637	1737	1847	1947
Rothwell: Columbus Cres Cook Cl	1639	1739	1849	1949
Rothwell: Kipton Field opp Drake Close	1642	1742	1852	1952
Glendon Hall: Rushton Rd / opp Hall	1646	1746	1856	1956
Glendon: Rushton Rd / opp Lodge Cottage	1647	1747	1857	1957
Kettering North Business Park Rockingham Road So	1650	1750	1900	2000
Kettering: Rockingham Rd Rockingham Paddocks	1651	1751	1901	2001
Kettering: Rockingham Rd o/s The Beeswing PH	1652	1752	1902	2002
Kettering: Rockingham Rd Kingsley Ave	1653	1753	1903	2003
Kettering: Rockingham Rd Athletic Club	1655	1755	1905	2005
Kettering: Rockingham Rd Regent St	1657	1757	1907	2007
Kettering: Eskdall St Stop 6	1700	1800	1910	2010
Kettering: Victoria St opp School La	1701	1801	1911	2011
Kettering: Library Stop 11 Arr:	1705	1805	1915	2015

Key: Firm times shown as: 1200 Estimated times shown as: 1200

Notes:

SUC = Stagecoach

[Change Request](#) [Print](#)

Results compiled from a timetable database built on 08/11/2008 07:00:08

APPENDIX B



Help

Route Timetables

Change Request Print

Date: Monday 10 November to Friday 14 November

19 Kettering - Rothwell - Desborough

Notes	Operators							
	SUC	SUC	SUC	SUC	SUC	SUC	SUC	SUC
Kettering: Library Stop 11 Dep:	0630	0650	0710	0735	0805	0825	0850	0910
Kettering: London Rd Church Walk	0632	0652	0712	0737	0807	0827	0852	0912
Kettering: Horse Market Dalkeith Place	0633	0653	0713	0738	0808	0828	0853	0913
Kettering: Newland St Stop 5	0635	0655	0715	0740	0810	0830	0855	0915
Kettering: Lower Street A6003	0636	0656	0716	0741	0811	0831	0856	0916
Kettering: Rothwell Rd o/s Hospital	0638	0658	0718	0743	0813	0833	0858	0918
Kettering: Rothwell Rd opp Telford Way	--	--	--	--	--	--	0859	0919
Kettering: Telford Way Baron Ave	0640	0700	0720	0745	0815	0835	--	--
Kettering: Telford Way opp Enterprise Cl	0641	0701	0721	0746	0816	0836	--	--
Kettering: Telford Way Linnell Way	0643	0703	0723	0748	0818	0838	--	--
Kettering: Henson Way opp Torrige Cl	0643	0703	0723	0748	0818	0838	--	--
Kettering: Henson Way opp Riley Rd	0644	0704	0724	0749	0819	0839	--	--
Rothwell: Kettering Rd opp Jubilee Street	0649	0709	0729	0754	0824	0844	0904	0924
Rothwell: Kettering Rd opp Gordon Street	0649	0709	0729	0754	0824	0844	0904	0924
Rothwell: Kettering Rd Fox Street	0650	0710	0730	0755	0825	0845	0905	0925
Rothwell: Desborough Rd by The Mallings	0650	0710	0730	0755	0825	0845	0905	0925
Rothwell: Desborough Rd Greening Rd	0651	0711	0731	0756	0826	0846	0906	0926
Desborough: Rothwell Rd Pioneer Ave	0653	0713	0733	0758	0828	0848	0908	0928
Desborough: High St o/s Library	--	0715	0735	--	0830	--	0910	0930
Desborough: Harborough Rd Ironwood Avenue Arr:	--	--	0738	--	--	--	0913	--
Desborough: High St Chip Shop	0655	--	--	0800	--	0850	--	--
Desborough: Dunkirk Ave Paddock La	0656	--	--	0801	--	0851	--	--
Desborough: Dunkirk Ave opp Breakleys Rd	0658	--	--	0803	--	0853	--	--
Desborough: Ise Vale Ave Dunkirk Ave	--	--	--	--	--	--	--	--
Desborough: Ise Vale Ave Broadlands	--	--	--	--	--	--	--	--
Desborough: Broadlands Chestnut Drive	--	--	--	--	--	--	--	--
Desborough: Broadlands opp Redwood Cl	--	--	--	--	--	--	--	--
Desborough: Rushton Rd opp the Cemetery	--	--	--	--	--	--	--	--
Desborough: Rushton Rd Mayfield Rd	--	--	--	--	--	--	--	--
Desborough: Rushton Rd Union St	--	--	--	--	--	--	--	--
Desborough: Station Rd Queen St	--	--	--	--	--	--	--	--
Desborough:Gold St Harrington Rd	--	0716	--	--	0831	--	--	0931
Desborough: Braybrooke Rd opp Hilltop Arr:	--	0718	--	--	0833	--	--	0933

Key: Firm times shown as: 1200 Estimated times shown as: 1200

Notes	Operators							
	SUC	SUC	SUC	SUC	SUC	SUC	SUC	SUC
Kettering: Library Stop 11 Dep:	0930	0950	1010	1030	1050	1110	1130	1150
Kettering: London Rd Church Walk	0932	0952	1012	1032	1052	1112	1132	1152
Kettering: Horse Market Dalkeith Place	0933	0953	1013	1033	1053	1113	1133	1153
Kettering: Newland St Stop 5	0935	0955	1015	1035	1055	1115	1135	1155
Kettering: Lower Street A6003	0936	0956	1016	1036	1056	1116	1136	1156
Kettering: Rothwell Rd o/s Hospital	0938	0958	1018	1038	1058	1118	1138	1158
Kettering: Rothwell Rd opp Telford Way	0939	0959	1019	1039	1059	1119	1139	1159
Kettering: Telford Way Baron Ave	--	--	--	--	--	--	--	--
Kettering: Telford Way opp Enterprise Cl	--	--	--	--	--	--	--	--
Kettering: Telford Way Linnell Way	--	--	--	--	--	--	--	--
Kettering: Henson Way opp Torrige Cl	--	--	--	--	--	--	--	--
Kettering: Henson Way opp Riley Rd	--	--	--	--	--	--	--	--
Rothwell: Kettering Rd opp Jubilee Street	0944	1004	1024	1044	1104	1124	1144	1204
Rothwell: Kettering Rd opp Gordon Street	0944	1004	1024	1044	1104	1124	1144	1204
Rothwell: Kettering Rd Fox Street	0945	1005	1025	1045	1105	1125	1145	1205
Rothwell: Desborough Rd by The Mallings	0945	1005	1025	1045	1105	1125	1145	1205
Rothwell: Desborough Rd Greening Rd	0946	1006	1026	1046	1106	1126	1146	1206
Desborough: Rothwell Rd Pioneer Ave	0948	1008	1028	1048	1108	1128	1148	1208
Desborough: High St o/s Library	--	1010	1030	--	1110	1130	--	1210
Desborough: Harborough Rd Ironwood Avenue Arr:	--	1013	--	--	1113	--	--	1213
Desborough: High St Chip Shop	0950	--	--	1050	--	--	1150	--
Desborough: Dunkirk Ave Paddock La	0951	--	--	1051	--	--	1151	--
Desborough: Dunkirk Ave opp Breakleys Rd	0953	--	--	1053	--	--	1153	--
Desborough: Ise Vale Ave Dunkirk Ave	--	--	--	--	--	--	--	--
Desborough: Ise Vale Ave Broadlands	--	--	--	--	--	--	--	--
Desborough: Broadlands Chestnut Drive	--	--	--	--	--	--	--	--
Desborough: Broadlands opp Redwood Cl	--	--	--	--	--	--	--	--
Desborough: Rushton Rd opp the Cemetery	--	--	--	--	--	--	--	--
Desborough: Rushton Rd Mayfield Rd	--	--	--	--	--	--	--	--
Desborough: Rushton Rd Union St	--	--	--	--	--	--	--	--
Desborough: Station Rd Queen St	--	--	--	--	--	--	--	--
Desborough:Gold St Harrington Rd	--	--	1031	--	--	1131	--	--
Desborough: Braybrooke Rd opp Hilltop Arr:	--	--	1033	--	--	1133	--	--

Key: Firm times shown as: 1200 Estimated times shown as: 1200

Notes	Operators							
	SUC	SUC	SUC	SUC	SUC	SUC	SUC	SUC
Kettering: Library Stop 11 Dep:	1210	1230	1250	1310	1330	1350	1410	1430
Kettering: London Rd Church Walk	1212	1232	1252	1312	1332	1352	1412	1432
Kettering: Horse Market Dalkeith Place	1213	1233	1253	1313	1333	1353	1413	1433
Kettering: Newland St Stop 5	1215	1235	1255	1315	1335	1355	1415	1435
Kettering: Lower Street A6003	1216	1236	1256	1316	1336	1356	1416	1436
Kettering: Rothwell Rd o/s Hospital	1218	1238	1258	1318	1338	1358	1418	1438
Kettering: Rothwell Rd opp Telford Way	1219	1239	1259	1319	1339	1359	1419	1439
Kettering: Telford Way Baron Ave	--	--	--	--	--	--	--	--
Kettering: Telford Way opp Enterprise Cl	--	--	--	--	--	--	--	--
Kettering: Telford Way Linnell Way	--	--	--	--	--	--	--	--
Kettering: Henson Way opp Torrige Cl	--	--	--	--	--	--	--	--
Kettering: Henson Way opp Riley Rd	--	--	--	--	--	--	--	--
Rothwell: Kettering Rd opp Jubilee Street	1224	1244	1304	1324	1344	1404	1424	1444
Rothwell: Kettering Rd opp Gordon Street	1224	1244	1304	1324	1344	1404	1424	1444
Rothwell: Kettering Rd Fox Street	1225	1245	1305	1325	1345	1405	1425	1445
Rothwell: Desborough Rd by The Mallings	1225	1245	1305	1325	1345	1405	1425	1445
Rothwell: Desborough Rd Greening Rd	1226	1246	1306	1326	1346	1406	1426	1446
Desborough: Rothwell Rd Pioneer Ave	1228	1248	1308	1328	1348	1408	1428	1448
Desborough: High St o/s Library	1230	--	1310	1330	--	1410	1430	--
Desborough: Harborough Rd Ironwood Avenue Arr:	--	--	1313	--	--	1413	--	--
Desborough: High St Chip Shop	--	1250	--	--	1350	--	--	1450
Desborough: Dunkirk Ave Paddock La	--	1251	--	--	1351	--	--	1451
Desborough: Dunkirk Ave opp Breakleys Rd	--	1253	--	--	1353	--	--	1453
Desborough: Ise Vale Ave Dunkirk Ave	--	--	--	--	--	--	--	--
Desborough: Ise Vale Ave Broadlands	--	--	--	--	--	--	--	--
Desborough: Broadlands Chestnut Drive	--	--	--	--	--	--	--	--

Desborough: Broadlands opp Redwood Cl	--	--	--	--	--	--	--	--
Desborough: Rushlon Rd opp the Cemetery	--	--	--	--	--	--	--	--
Desborough: Rushlon Rd Hayfield Rd	--	--	--	--	--	--	--	--
Desborough: Rushlon Rd Union St	--	--	--	--	--	--	--	--
Desborough: Station Rd Queen St	--	--	--	--	--	--	--	--
Desborough:Gold St Harrington Rd	1231	--	--	1331	--	--	1431	--
Desborough: Braybrooke Rd opp HStop Arr:	1233	--	--	1333	--	--	1433	--

Key: Firm times shown as: 1200 Estimated times shown as: 1200

Notes	Operators							
	SUC	SUC	SUC	SUC	SUC	SUC	SUC	SUC
Ketterling: Library Stop 11 Dep:	1450	1510	1530	1550	1610	1630	1655	1715
Ketterling: London Rd Church Walk	1452	1512	1532	1552	1612	1632	1657	1717
Ketterling: Horse Market Dalkeith Place	1453	1513	1533	1553	1613	1633	1658	1718
Ketterling: Nowland St Stop 5	1455	1515	1535	1555	1615	1635	1700	1720
Ketterling: Lower Street A5003	1456	1516	1536	1556	1616	1636	1701	1721
Ketterling: Rothwell Rd o/s Hospital	1458	1518	1538	1558	1618	1638	1703	1723
Ketterling: Rothwell Rd opp Telford Way	1459	1519	1539	1559	1619	1639	1704	1724
Ketterling: Telford Way Barton Ave	--	--	--	--	--	--	--	--
Ketterling: Telford Way opp Enterprise Cl	--	--	--	--	--	--	--	--
Ketterling: Telford Way Linnell Way	--	--	--	--	--	--	--	--
Ketterling: Henson Way opp Torridge Cl	--	--	--	--	--	--	--	--
Ketterling: Henson Way opp Riley Rd	--	--	--	--	--	--	--	--
Rothwell: Ketterling Rd opp Jubilee Street	1504	1524	1544	1604	1624	1644	1709	1729
Rothwell: Ketterling Rd opp Gordon Street	1504	1524	1544	1604	1624	1644	1709	1729
Rothwell: Ketterling Rd Fox Street	1505	1525	1545	1605	1625	1645	1710	1730
Rothwell: Desborough Rd by The Mallings	1505	1525	1545	1605	1625	1645	1710	1730
Rothwell: Desborough Rd Greening Rd	1506	1526	1546	1606	1626	1646	1711	1731
Desborough: Rothwell Rd Pioneer Ave	1508	1528	1548	1608	1628	1648	1713	1733
Desborough: High St o/s Library	1510	1530	--	1610	1630	--	1715	1735
Desborough: Harborough Rd Ironwood Avenue Arr:	1513	--	--	1613	--	--	1718	--
Desborough: High St Chip Shop	--	--	--	1550	--	--	1650	--
Desborough: Dunkirk Ave Paddock La	--	--	--	1551	--	--	1651	--
Desborough: Dunkirk Ave opp Breakkeys Rd	--	--	--	1553	--	--	1653	--
Desborough: Ise Vale Ave Dunkirk Ave	--	--	--	--	--	--	--	--
Desborough: Ise Vale Ave Broadlands	--	--	--	--	--	--	--	--
Desborough: Broadlands Chestnut Drive	--	--	--	--	--	--	--	--
Desborough: Broadlands opp Redwood Cl	--	--	--	--	--	--	--	--
Desborough: Rushlon Rd opp the Cemetery	--	--	--	--	--	--	--	--
Desborough: Rushlon Rd Hayfield Rd	--	--	--	--	--	--	--	--
Desborough: Rushlon Rd Union St	--	--	--	--	--	--	--	--
Desborough: Station Rd Queen St	--	--	--	--	--	--	--	--
Desborough:Gold St Harrington Rd	--	1531	--	--	1631	--	--	1738
Desborough: Braybrooke Rd opp HStop Arr:	--	1533	--	--	1633	--	--	1738

Key: Firm times shown as: 1200 Estimated times shown as: 1200

Notes	Operators								Fr
	SUC	SUC	SUC	SUC	SUC	SUC	SUC	SUC	
Ketterling: Library Stop 11 Dep:	1735	1755	1815	1835	1935	2035	2135	2305	
Ketterling: London Rd Church Walk	1737	1757	1817	1837	1937	2037	2137	2307	
Ketterling: Horse Market Dalkeith Place	1739	1758	1818	1838	1938	2038	2138	2308	
Ketterling: Nowland St Stop 5	1740	1800	1820	1840	1940	2040	2140	2310	
Ketterling: Lower Street A5003	1741	1801	1821	1841	1941	2041	2141	2311	
Ketterling: Rothwell Rd o/s Hospital	1743	1803	1823	1843	1943	2043	2143	2313	
Ketterling: Rothwell Rd opp Telford Way	1744	1804	1824	1844	1944	2044	2144	2314	
Ketterling: Telford Way Barton Ave	--	--	--	--	--	--	--	--	
Ketterling: Telford Way opp Enterprise Cl	--	--	--	--	--	--	--	--	
Ketterling: Telford Way Linnell Way	--	--	--	--	--	--	--	--	
Ketterling: Henson Way opp Torridge Cl	--	--	--	--	--	--	--	--	
Ketterling: Henson Way opp Riley Rd	--	--	--	--	--	--	--	--	
Rothwell: Ketterling Rd opp Jubilee Street	1749	1809	1829	1849	1949	2049	2149	2319	
Rothwell: Ketterling Rd opp Gordon Street	1749	1809	1829	1849	1949	2049	2149	2319	
Rothwell: Ketterling Rd Fox Street	1750	1810	1830	1850	1950	2050	2150	2320	
Rothwell: Desborough Rd by The Mallings	1750	1810	1830	1850	1950	2050	2150	2320	
Rothwell: Desborough Rd Greening Rd	1751	1811	1831	1851	1951	2051	2151	2321	
Desborough: Rothwell Rd Pioneer Ave	1753	1813	1833	1853	1953	2053	2153	2323	
Desborough: High St o/s Library	--	1815	1835	--	--	--	--	--	
Desborough: Harborough Rd Ironwood Avenue Arr:	--	1818	--	--	--	--	--	--	
Desborough: High St Chip Shop	1755	--	--	1855	1955	2055	2155	2325	
Desborough: Dunkirk Ave Paddock La	1756	--	--	1856	1956	2056	2156	2326	
Desborough: Dunkirk Ave opp Breakkeys Rd	1758	--	--	1858	1958	2058	2158	2328	
Desborough: Ise Vale Ave Dunkirk Ave	--	--	--	--	--	--	2158	2328	
Desborough: Ise Vale Ave Broadlands	--	--	--	--	--	--	2159	2329	
Desborough: Broadlands Chestnut Drive	--	--	--	--	--	--	2159	2329	
Desborough: Broadlands opp Redwood Cl	--	--	--	--	--	--	2200	2330	
Desborough: Rushlon Rd opp the Cemetery	--	--	--	--	--	--	2200	2330	
Desborough: Rushlon Rd Hayfield Rd	--	--	--	--	--	--	2200	2330	
Desborough: Rushlon Rd Union St	--	--	--	--	--	--	2201	2331	
Desborough: Station Rd Queen St	--	--	--	--	--	--	2201	2331	
Desborough:Gold St Harrington Rd	--	--	1836	--	--	--	2202	2332	
Desborough: Braybrooke Rd opp HStop Arr:	--	--	1838	--	--	--	2203	2333	

Key: Firm times shown as: 1200 Estimated times shown as: 1200

Notes:

SUC = Stagecoach
Fr = Fiday Only

Results compiled from a timetable database built on 08/11/2008 07:00:08



Help

Route Timetables

Change Request Print

Date: Monday 10 November to Friday 14 November

19 Desborough - Rothwell - Kettering

Notes									
Operators	SUC	SUC	SUC	SUC	SUC	SUC	SUC	SUC	SUC
Service Number	19	19	19	19	19	19	19	19	19
Desborough: Dunkirk Ave Paddock La Dep:	0635	--	--	--	--	--	--	--	--
Desborough: Dunkirk Ave opp Breakleys Rd	0635	0700	--	--	0805	--	0855	--	--
Desborough: Braybrooke Rd opp Hilltop	0640	--	0720	--	--	0835	--	--	--
Desborough: Braybrooke Rd Sports Ground	0640	--	0720	--	--	0835	--	--	--
Desborough: Gold Street opp Harrington Rd	0642	--	0723	--	--	0838	--	--	--
Desborough: Harborough Rd Ironwood Avenue Dep:	--	--	--	0745	--	--	--	0915	--
Desborough: High St Chip Shop	0645	0705	0725	0750	0810	0840	0900	0920	--
Desborough: Lower St Church	0646	0706	0726	0751	0811	0841	0901	0921	--
Desborough: St Anthony's Hill opp Federation Av	0647	0707	0727	0752	0812	0842	0902	0922	--
Desborough: Rothwell Rd opp Pioneer Ave	0647	0707	0727	0752	0812	0842	0902	0922	--
Rothwell: Desborough Rd opp Greening Rd	0651	0711	0731	0756	0816	0846	0906	0926	--
Rothwell: High Street War Memorial	0652	0712	0732	0757	0817	0847	0907	0927	--
Rothwell: Kettering Rd Gordon Street	0653	0713	0733	0758	0818	0848	0908	0928	--
Rothwell: Kettering Rd Jubilee Street	0653	0713	0733	0758	0818	0848	0908	0928	--
opp The Woodlands Hospital A14	0656	0716	0736	0801	0821	0851	0911	0931	--
Kettering: Henson Way opp Hotel	--	--	--	--	--	--	--	--	--
Kettering: Henson Way Wyndham Way	--	--	--	--	--	--	--	--	--
Kettering: Henson Way Riley Rd	--	--	--	--	--	--	--	--	--
Kettering: Henson Way Torridge Cl	--	--	--	--	--	--	--	--	--
Kettering: Telford Way opp Linnell Way	--	--	--	--	--	--	--	--	--
Kettering: Telford Way Robinson Way	--	--	--	--	--	--	--	--	--
Kettering: Telford Way opp Baron Ave	--	--	--	--	--	--	--	--	--
Kettering: Rothwell Rd Telford Way	0658	0718	0738	0803	0823	0853	0913	0933	--
Kettering: Rothwell Rd opp Hospital	0659	0719	0739	0804	0824	0854	0914	0934	--
Kettering: Eskdail St Stop 6	0707	0727	0747	0812	0832	0902	0920	0940	--
Kettering: Victoria St opp School La	0708	0728	0748	0813	0833	0903	0921	0941	--
Kettering: Library Stop 11 Arr:	0710	0730	0750	0815	0835	0905	0923	0943	--

Key: Firm times shown as: 1200 Estimated times shown as: 1200

Notes									
Operators	SUC	SUC	SUC	SUC	SUC	SUC	SUC	SUC	SUC
Service Number	19	19	19	19	19	19	19	19	19
Desborough: Dunkirk Ave Paddock La Dep:	--	--	--	--	--	--	--	--	--
Desborough: Dunkirk Ave opp Breakleys Rd	--	0955	--	--	1055	--	--	1155	--
Desborough: Braybrooke Rd opp Hilltop	0935	--	--	1035	--	--	1135	--	--
Desborough: Harborough Rd Ironwood Avenue Dep:	--	--	1015	--	--	1115	--	--	--
Kettering: Library Stop 11 Arr:	1003	1023	1043	1103	1123	1143	1203	1223	--

Key: Firm times shown as: 1200 Estimated times shown as: 1200

Notes									
Operators	SUC	SUC	SUC	SUC	SUC	SUC	SUC	SUC	SUC
Service Number	19	19	19	19	19	19	19	19	19
Desborough: Dunkirk Ave Paddock La Dep:	--	--	--	--	--	--	--	--	--
Desborough: Dunkirk Ave opp Breakleys Rd	--	--	1255	--	--	1355	--	--	--
Desborough: Braybrooke Rd opp Hilltop	--	1235	--	--	1335	--	--	1435	--
Desborough: Braybrooke Rd Sports Ground	--	1235	--	--	1335	--	--	1435	--
Desborough: Gold Street opp Harrington Rd	--	1238	--	--	1338	--	--	1438	--
Desborough: Harborough Rd Ironwood Avenue Dep:	1215	--	--	1315	--	--	1415	--	--
Desborough: High St Chip Shop	1220	1240	1300	1320	1340	1400	1420	1440	--
Desborough: Lower St Church	1221	1241	1301	1321	1341	1401	1421	1441	--
Desborough: St Anthony's Hill opp Federation Av	1222	1242	1302	1322	1342	1402	1422	1442	--
Desborough: Rothwell Rd opp Pioneer Ave	1222	1242	1302	1322	1342	1402	1422	1442	--
Rothwell: Desborough Rd opp Greening Rd	1226	1246	1306	1326	1346	1406	1426	1446	--
Rothwell: High Street War Memorial	1227	1247	1307	1327	1347	1407	1427	1447	--
Rothwell: Kettering Rd Gordon Street	1228	1248	1308	1328	1348	1408	1428	1448	--
Rothwell: Kettering Rd Jubilee Street	1228	1248	1308	1328	1348	1408	1428	1448	--
opp The Woodlands Hospital A14	1231	1251	1311	1331	1351	1411	1431	1451	--
Kettering: Henson Way opp Hotel	--	--	--	--	--	--	--	--	--
Kettering: Henson Way Wyndham Way	--	--	--	--	--	--	--	--	--
Kettering: Henson Way Riley Rd	--	--	--	--	--	--	--	--	--
Kettering: Henson Way Torridge Cl	--	--	--	--	--	--	--	--	--
Kettering: Telford Way opp Linnell Way	--	--	--	--	--	--	--	--	--

Kettering: Telford Way Robinson Way	--	--	--	--	--	--	--	--
Kettering: Telford Way opp Baron Ave	--	--	--	--	--	--	--	--
Kettering: Rothwell Rd Telford Way	1233	1253	1313	1333	1353	1413	1433	1453
Kettering: Rothwell Rd opp Hospital	1234	1254	1314	1334	1354	1414	1434	1454
Kettering: Eskdaill St Stop 6	1240	1300	1320	1340	1400	1420	1440	1500
Kettering: Victoria St opp School La	1241	1301	1321	1341	1401	1421	1441	1501
Kettering: Library Stop 11 Arr:	1243	1303	1323	1343	1403	1423	1443	1503

Key: Firm times shown as: 1200 Estimated times shown as: 1200

Notes	Operators								
	SUC	SUC	SUC	SUC	SUC	SUC	SUC	SUC	SUC
Service Number	19	19	19	19	19	19	19	19	19
Desborough: Dunkirk Ave Paddock La Dep:	--	--	--	--	--	--	--	--	--
Desborough: Dunkirk Ave opp Breakleys Rd	1455	--	--	1555	--	--	1655	--	--
Desborough: Braybrooke Rd opp Hilltop	--	--	1535	--	--	1635	--	--	--
Desborough: Braybrooke Rd Sports Ground	--	--	1535	--	--	1635	--	--	--
Desborough: Gold Street opp Harrington Rd	--	--	1538	--	--	1638	--	--	--
Desborough: Harborough Rd Ironwood Avenue Dep:	--	1515	--	--	1615	--	--	1720	--
Desborough: High St Chip Shop	1500	1520	1540	1600	1620	1640	1700	1725	--
Desborough: Lower St Church	1501	1521	1541	1601	1621	1641	1701	1726	--
Desborough: St Anthony's Hill opp Federation Av	1502	1522	1542	1602	1622	1642	1702	1727	--
Desborough: Rothwell Rd opp Pioneer Ave	1502	1522	1542	1602	1622	1642	1702	1727	--
Rothwell: Desborough Rd opp Greening Rd	1506	1526	1546	1606	1626	1646	1706	1731	--
Rothwell: High Street War Memorial	1507	1527	1547	1607	1627	1647	1707	1732	--
Rothwell: Kettering Rd Gordon Street	1508	1528	1548	1608	1628	1648	1708	1733	--
Rothwell: Kettering Rd Jubilee Street	1508	1528	1548	1608	1628	1648	1708	1733	--
opp The Woodlands Hospital A14	1511	1531	1551	1611	1631	1651	1711	1736	--
Kettering: Henson Way opp Hotel	--	--	--	--	1633	1653	1713	1738	--
Kettering: Henson Way Wyndham Way	--	--	--	--	1633	1653	1713	1738	--
Kettering: Henson Way Riley Rd	--	--	--	--	1634	1654	1714	1739	--
Kettering: Henson Way Torridge Cl	--	--	--	--	1634	1654	1714	1739	--
Kettering: Telford Way opp Linnell Way	--	--	--	--	1634	1654	1714	1739	--
Kettering: Telford Way Robinson Way	--	--	--	--	1635	1655	1715	1740	--
Kettering: Telford Way opp Baron Ave	--	--	--	--	1636	1656	1716	1741	--
Kettering: Rothwell Rd Telford Way	1513	1533	1553	1613	--	--	--	--	--
Kettering: Rothwell Rd opp Hospital	1514	1534	1554	1614	1639	1659	1719	1744	--
Kettering: Eskdaill St Stop 6	1520	1540	1600	1620	1645	1705	1725	1750	--
Kettering: Victoria St opp School La	1521	1541	1601	1621	1646	1706	1726	1751	--
Kettering: Library Stop 11 Arr:	1523	1543	1603	1623	1648	1708	1728	1753	--

Key: Firm times shown as: 1200 Estimated times shown as: 1200

Notes	Operators								Fr
	SUC	SUC	SUC	SUC	SUC	SUC	SUC	SUC	SUC
Service Number	19	19	19	19	19	19	19	19	19
Desborough: Dunkirk Ave Paddock La Dep:	--	--	--	--	--	--	--	--	--
Desborough: Dunkirk Ave opp Breakleys Rd	--	1800	--	1900	2000	2100	--	--	--
Desborough: Braybrooke Rd opp Hilltop	1740	--	1840	--	--	--	2205	2335	--
Desborough: Braybrooke Rd Sports Ground	1740	--	1840	--	--	--	2205	2335	--
Desborough: Gold Street opp Harrington Rd	1743	--	1843	--	--	--	2208	2338	--
Desborough: Harborough Rd Ironwood Avenue Dep:	--	--	--	--	--	--	--	--	--
Desborough: High St Chip Shop	1745	1805	1845	1905	2005	2105	2210	2340	--
Desborough: Lower St Church	1746	1806	1846	1906	2006	2106	2211	2341	--
Desborough: St Anthony's Hill opp Federation Av	1747	1807	1847	1907	2007	2107	2212	2342	--
Desborough: Rothwell Rd opp Pioneer Ave	1747	1807	1847	1907	2007	2107	2212	2342	--
Rothwell: Desborough Rd opp Greening Rd	1751	1811	1851	1911	2011	2111	2216	2346	--
Rothwell: High Street War Memorial	1752	1812	1852	1912	2012	2112	2217	2347	--
Rothwell: Kettering Rd Gordon Street	1753	1813	1853	1913	2013	2113	2218	2348	--
Rothwell: Kettering Rd Jubilee Street	1753	1813	1853	1913	2013	2113	2218	2348	--
opp The Woodlands Hospital A14	1756	1816	1856	1916	2016	2116	2221	2351	--
Kettering: Henson Way opp Hotel	--	--	--	--	--	--	--	--	--
Kettering: Henson Way Wyndham Way	--	--	--	--	--	--	--	--	--
Kettering: Henson Way Riley Rd	--	--	--	--	--	--	--	--	--
Kettering: Henson Way Torridge Cl	--	--	--	--	--	--	--	--	--
Kettering: Telford Way opp Linnell Way	--	--	--	--	--	--	--	--	--
Kettering: Telford Way Robinson Way	--	--	--	--	--	--	--	--	--
Kettering: Telford Way opp Baron Ave	--	--	--	--	--	--	--	--	--
Kettering: Rothwell Rd Telford Way	1758	1818	1858	1918	2018	2118	2223	2353	--
Kettering: Rothwell Rd opp Hospital	1759	1819	1859	1919	2019	2119	2224	2354	--
Kettering: Eskdaill St Stop 6	1807	1827	1907	1927	2027	2127	2232	0002	--
Kettering: Victoria St opp School La	1808	1828	1908	1928	2028	2128	2233	0003	--
Kettering: Library Stop 11 Arr:	1810	1830	1910	1930	2030	2130	2235	0005	--

Key: Firm times shown as: 1200 Estimated times shown as: 1200

Notes:

SUC = Stagecoach
Fr = Friday Only

[Change Request](#) [Print](#)

Results compiled from a timetable database built on 08/11/2008 07:00:08



Help

Route Timetables

Change Request Print

Date: Saturday 15 November

19 Desborough - Rothwell - Kettering

Notes								
Operators	SUC	SUC	SUC	SUC	SUC	SUC	SUC	SUC
Service Number	19	19	19	19	19	19	19	19
Desborough: Harborough Rd Ironwood Avenue Dep:	0745	--	--	--	0915	--	--	1015
Desborough: Dunkirk Ave opp Breakleys Rd Dep:	--	0805	--	0855	--	--	0955	--
Desborough: Braybrooke Rd opp Hilltop Dep:	--	--	0835	--	--	0935	--	--
Desborough: Braybrooke Rd Sports Ground	--	--	0835	--	--	0935	--	--
Desborough: Gold Street opp Harrington Rd	--	--	0838	--	--	0938	--	--
Desborough: High St Chip Shop	0750	0810	0840	0900	0920	0940	1000	1020
Desborough: Lower St Church	0751	0811	0841	0901	0921	0941	1001	1021
Desborough: St Anthony's Hill opp Federation Av	0752	0812	0842	0902	0922	0942	1002	1022
Desborough: Rothwell Rd opp Pioneer Ave	0752	0812	0842	0902	0922	0942	1002	1022
Rothwell: Desborough Rd opp Greening Rd	0756	0816	0846	0906	0926	0946	1006	1026
Rothwell: High Street War Memorial	0757	0817	0847	0907	0927	0947	1007	1027
Rothwell: Kettering Rd Gordon Street	0758	0818	0848	0908	0928	0948	1008	1028
Rothwell: Kettering Rd Jubilee Street	0758	0818	0848	0908	0928	0948	1008	1028
opp The Woodlands Hospital A14	0801	0821	0851	0911	0931	0951	1011	1031
Kettering: Henson Way opp Hotel	--	--	--	--	--	--	--	--
Kettering: Henson Way Wyndham Way	--	--	--	--	--	--	--	--
Kettering: Henson Way Riley Rd	--	--	--	--	--	--	--	--
Kettering: Henson Way Torridge Cl	--	--	--	--	--	--	--	--
Kettering: Telford Way opp Linnell Way	--	--	--	--	--	--	--	--
Kettering: Telford Way Robinson Way	--	--	--	--	--	--	--	--
Kettering: Telford Way opp Baron Ave	--	--	--	--	--	--	--	--
Kettering: Rothwell Rd Telford Way	0803	0823	0853	0913	0933	0953	1013	1033
Kettering: Rothwell Rd opp Hospital	0804	0824	0854	0914	0934	0954	1014	1034
Kettering: Eskdail St Stop 6	0812	0832	0902	0920	0940	1000	1020	1040
Kettering: Victoria St opp School La	0813	0833	0903	0921	0941	1001	1021	1041
Kettering: Library Stop 11 Arr:	0815	0835	0905	0923	0943	1003	1023	1043

Key: Firm times shown as: 1200 Estimated times shown as: 1200

Notes								
Operators	SUC	SUC	SUC	SUC	SUC	SUC	SUC	SUC
Service Number	19	19	19	19	19	19	19	19
Desborough: Harborough Rd Ironwood Avenue Dep:	--	--	1115	--	--	1215	--	--
Desborough: Dunkirk Ave opp Breakleys Rd Dep:	--	1055	--	--	1155	--	--	1255
Desborough: Braybrooke Rd opp Hilltop Dep:	1035	--	--	1135	--	--	1235	--
Desborough: Braybrooke Rd Sports Ground	1035	--	--	1135	--	--	1235	--
Desborough: Gold Street opp Harrington Rd	1038	--	--	1138	--	--	1238	--
Desborough: High St Chip Shop	1040	1100	1120	1140	1200	1220	1240	1300
Desborough: Lower St Church	1041	1101	1121	1141	1201	1221	1241	1301
Desborough: St Anthony's Hill opp Federation Av	1042	1102	1122	1142	1202	1222	1242	1302
Desborough: Rothwell Rd opp Pioneer Ave	1042	1102	1122	1142	1202	1222	1242	1302
Rothwell: Desborough Rd opp Greening Rd	1046	1106	1126	1146	1206	1226	1246	1306
Rothwell: High Street War Memorial	1047	1107	1127	1147	1207	1227	1247	1307
Rothwell: Kettering Rd Gordon Street	1048	1108	1128	1148	1208	1228	1248	1308
Rothwell: Kettering Rd Jubilee Street	1048	1108	1128	1148	1208	1228	1248	1308
opp The Woodlands Hospital A14	1051	1111	1131	1151	1211	1231	1251	1311
Kettering: Henson Way opp Hotel	--	--	--	--	--	--	--	--
Kettering: Henson Way Wyndham Way	--	--	--	--	--	--	--	--
Kettering: Henson Way Riley Rd	--	--	--	--	--	--	--	--
Kettering: Henson Way Torridge Cl	--	--	--	--	--	--	--	--
Kettering: Telford Way opp Linnell Way	--	--	--	--	--	--	--	--
Kettering: Telford Way Robinson Way	--	--	--	--	--	--	--	--
Kettering: Telford Way opp Baron Ave	--	--	--	--	--	--	--	--
Kettering: Rothwell Rd Telford Way	1053	1113	1133	1153	1213	1233	1253	1313
Kettering: Rothwell Rd opp Hospital	1054	1114	1134	1154	1214	1234	1254	1314
Kettering: Eskdail St Stop 6	1100	1120	1140	1200	1220	1240	1300	1320
Kettering: Victoria St opp School La	1101	1121	1141	1201	1221	1241	1301	1321
Kettering: Library Stop 11 Arr:	1103	1123	1143	1203	1223	1243	1303	1323

Key: Firm times shown as: 1200 Estimated times shown as: 1200

Notes								
Operators	SUC	SUC	SUC	SUC	SUC	SUC	SUC	SUC
Service Number	19	19	19	19	19	19	19	19
Desborough: Harborough Rd Ironwood Avenue Dep:	1315	--	--	1415	--	--	1515	--
Desborough: Dunkirk Ave opp Breakleys Rd Dep:	--	--	1355	--	--	1455	--	--
Desborough: Braybrooke Rd opp Hilltop Dep:	--	1335	--	--	1435	--	--	1535
Desborough: Braybrooke Rd Sports Ground	--	1335	--	--	1435	--	--	1535
Desborough: Gold Street opp Harrington Rd	--	1338	--	--	1438	--	--	1538
Desborough: High St Chip Shop	1320	1340	1400	1420	1440	1500	1520	1540
Desborough: Lower St Church	1321	1341	1401	1421	1441	1501	1521	1541

Desborough: St Anthony's Hill opp Federation Av	1322	1342	1402	1422	1442	1502	1522	1542
Desborough: Rothwell Rd opp Pioneer Ave	1322	1342	1402	1422	1442	1502	1522	1542
Rothwell: Desborough Rd opp Greening Rd	1326	1346	1406	1426	1446	1506	1526	1546
Rothwell: High Street War Memorial	1327	1347	1407	1427	1447	1507	1527	1547
Rothwell: Kettering Rd Gordon Street	1328	1348	1408	1428	1448	1508	1528	1548
Rothwell: Kettering Rd Jubilee Street	1328	1348	1408	1428	1448	1508	1528	1548
opp The Woodlands Hospital A14	1331	1351	1411	1431	1451	1511	1531	1551
Kettering: Henson Way opp Hotel	--	--	--	--	--	--	--	--
Kettering: Henson Way Wyndham Way	--	--	--	--	--	--	--	--
Kettering: Henson Way Riley Rd	--	--	--	--	--	--	--	--
Kettering: Henson Way Torridge Cl	--	--	--	--	--	--	--	--
Kettering: Telford Way opp Linnell Way	--	--	--	--	--	--	--	--
Kettering: Telford Way Robinson Way	--	--	--	--	--	--	--	--
Kettering: Telford Way opp Baron Ave	--	--	--	--	--	--	--	--
Kettering: Rothwell Rd Telford Way	1333	1353	1413	1433	1453	1513	1533	1553
Kettering: Rothwell Rd opp Hospital	1334	1354	1414	1434	1454	1514	1534	1554
Kettering: Eskdall St Stop 6	1340	1400	1420	1440	1500	1520	1540	1600
Kettering: Victoria St opp School La	1341	1401	1421	1441	1501	1521	1541	1601
Kettering: Library Stop 11 Arr:	1343	1403	1423	1443	1503	1523	1543	1603

Key: Firm times shown as: 1200 Estimated times shown as: 1200

Notes									
Operators	SUC	SUC	SUC	SUC	SUC	SUC	SUC	SUC	SUC
Service Number	19	19	19	19	19	19	19	19	19
Desborough: Harborough Rd Ironwood Avenue Dep:	--	1615	--	--	1720	--	--	--	--
Desborough: Dunkirk Ave opp Breakleys Rd Dep:	1555	--	--	1655	--	--	1800	--	--
Desborough: Braybrooke Rd opp Hilltop Dep:	--	--	1635	--	--	1740	--	1840	--
Desborough: Braybrooke Rd Sports Ground	--	--	1635	--	--	1740	--	1840	--
Desborough: Gold Street opp Harrington Rd	--	--	1638	--	--	1743	--	1843	--
Desborough: High St Chip Shop	1600	1620	1640	1700	1725	1745	1805	1845	--
Desborough: Lower St Church	1601	1621	1641	1701	1726	1746	1806	1846	--
Desborough: St Anthony's Hill opp Federation Av	1602	1622	1642	1702	1727	1747	1807	1847	--
Desborough: Rothwell Rd opp Pioneer Ave	1602	1622	1642	1702	1727	1747	1807	1847	--
Rothwell: Desborough Rd opp Greening Rd	1606	1626	1646	1706	1731	1751	1811	1851	--
Rothwell: High Street War Memorial	1607	1627	1647	1707	1732	1752	1812	1852	--
Rothwell: Kettering Rd Gordon Street	1608	1628	1648	1708	1733	1753	1813	1853	--
Rothwell: Kettering Rd Jubilee Street	1608	1628	1648	1708	1733	1753	1813	1853	--
opp The Woodlands Hospital A14	1611	1631	1651	1711	1736	1756	1816	1856	--
Kettering: Henson Way opp Hotel	--	1633	1653	1713	1738	--	--	--	--
Kettering: Henson Way Wyndham Way	--	1633	1653	1713	1738	--	--	--	--
Kettering: Henson Way Riley Rd	--	1634	1654	1714	1739	--	--	--	--
Kettering: Henson Way Torridge Cl	--	1634	1654	1714	1739	--	--	--	--
Kettering: Telford Way opp Linnell Way	--	1634	1654	1714	1739	--	--	--	--
Kettering: Telford Way Robinson Way	--	1635	1655	1715	1740	--	--	--	--
Kettering: Telford Way opp Baron Ave	--	1636	1656	1716	1741	--	--	--	--
Kettering: Rothwell Rd Telford Way	1613	--	--	--	1758	1818	1858	--	--
Kettering: Rothwell Rd opp Hospital	1614	1639	1659	1719	1744	1759	1819	1859	--
Kettering: Eskdall St Stop 6	1620	1645	1705	1725	1750	1807	1827	1907	--
Kettering: Victoria St opp School La	1621	1646	1706	1726	1751	1808	1828	1908	--
Kettering: Library Stop 11 Arr:	1623	1648	1708	1728	1753	1810	1830	1910	--

Key: Firm times shown as: 1200 Estimated times shown as: 1200

Notes					
Operators	SUC	SUC	SUC	SUC	SUC
Service Number	19	19	19	19	19
Desborough: Harborough Rd Ironwood Avenue Dep:	--	--	--	--	--
Desborough: Dunkirk Ave opp Breakleys Rd Dep:	1900	2000	2100	--	--
Desborough: Braybrooke Rd opp Hilltop Dep:	--	--	--	2205	2335
Desborough: Braybrooke Rd Sports Ground	--	--	--	2205	2335
Desborough: Gold Street opp Harrington Rd	--	--	--	2208	2338
Desborough: High St Chip Shop	1905	2005	2105	2210	2340
Desborough: Lower St Church	1906	2006	2106	2211	2341
Desborough: St Anthony's Hill opp Federation Av	1907	2007	2107	2212	2342
Desborough: Rothwell Rd opp Pioneer Ave	1907	2007	2107	2212	2342
Rothwell: Desborough Rd opp Greening Rd	1911	2011	2111	2216	2346
Rothwell: High Street War Memorial	1912	2012	2112	2217	2347
Rothwell: Kettering Rd Gordon Street	1913	2013	2113	2218	2348
Rothwell: Kettering Rd Jubilee Street	1913	2013	2113	2218	2348
opp The Woodlands Hospital A14	1916	2016	2116	2221	2351
Kettering: Henson Way opp Hotel	--	--	--	--	--
Kettering: Henson Way Wyndham Way	--	--	--	--	--
Kettering: Henson Way Riley Rd	--	--	--	--	--
Kettering: Henson Way Torridge Cl	--	--	--	--	--
Kettering: Telford Way opp Linnell Way	--	--	--	--	--
Kettering: Telford Way Robinson Way	--	--	--	--	--
Kettering: Telford Way opp Baron Ave	--	--	--	--	--
Kettering: Rothwell Rd Telford Way	1918	2018	2118	2223	2353
Kettering: Rothwell Rd opp Hospital	1919	2019	2119	2224	2354
Kettering: Eskdall St Stop 6	1927	2027	2127	2232	0002
Kettering: Victoria St opp School La	1928	2028	2128	2233	0003
Kettering: Library Stop 11 Arr:	1930	2030	2130	2235	0005

Key: Firm times shown as: 1200 Estimated times shown as: 1200

Notes:

SUC = Stagecoach



Help

Route Timetables

[Change Request](#) [Print](#)

Date: Saturday 15 November

19 Kettering - Rothwell - Desborough

Notes		SUC	SUC	SUC	SUC	SUC	SUC	SUC	SUC
Operators	Service Number	19	19	19	19	19	19	19	19
Kettering: Library Stop 11 Dep:		0735	0805	0825	0850	0910	0930	0950	1010
Kettering: London Rd Church Walk		0737	0807	0827	0852	0912	0932	0952	1012
Kettering: Horse Market Dalkeith Place		0738	0808	0828	0853	0913	0933	0953	1013
Kettering: Newland St Stop 5		0740	0810	0830	0855	0915	0935	0955	1015
Kettering: Lower Street A6003		0741	0811	0831	0856	0916	0936	0956	1016
Kettering: Rothwell Rd o/s Hospital		0743	0813	0833	0858	0918	0938	0958	1018
Kettering: Rothwell Rd opp Telford Way		--	--	--	0859	0919	0939	0959	1019
Kettering: Telford Way Baron Ave		0745	0815	0835	--	--	--	--	--
Kettering: Telford Way opp Enterprise Cl		0746	0816	0836	--	--	--	--	--
Kettering: Telford Way Linnell Way		0748	0818	0838	--	--	--	--	--
Kettering: Henson Way opp Torridge Cl		0748	0818	0838	--	--	--	--	--
Kettering: Henson Way opp Riley Rd		0749	0819	0839	--	--	--	--	--
Rothwell: Kettering Rd opp Jubilee Street		0754	0824	0844	0904	0924	0944	1004	1024
Rothwell: Kettering Rd opp Gordon Street		0754	0824	0844	0904	0924	0944	1004	1024
Rothwell: Kettering Rd Fox Street		0755	0825	0845	0905	0925	0945	1005	1025
Rothwell: Desborough Rd by The Maltings		0755	0825	0845	0905	0925	0945	1005	1025
Rothwell: Desborough Rd Greening Rd		0756	0826	0846	0906	0926	0946	1006	1026
Desborough: Rothwell Rd Pioneer Ave		0758	0828	0848	0908	0928	0948	1008	1028
Desborough: High St o/s Library		--	0830	--	0910	0930	--	1010	1030
Desborough: Harborough Rd Ironwood Avenue Arr:		--	--	--	0913	--	--	1013	--
Desborough: High St Chip Shop		0800	--	0850	--	--	0950	--	--
Desborough: Dunkirk Ave Paddock La		0801	--	0851	--	--	0951	--	--
Desborough: Dunkirk Ave opp Breakleys Rd		0803	--	0853	--	--	0953	--	--
Desborough: Braybrooke Rd opp Hilltop Arr:		--	0833	--	--	0933	--	--	1033

Key: Firm times shown as: 1200 Estimated times shown as: 1200

Notes		SUC	SUC	SUC	SUC	SUC	SUC	SUC	SUC
Operators	Service Number	19	19	19	19	19	19	19	19
Kettering: Library Stop 11 Dep:		1030	1050	1110	1130	1150	1210	1230	1250
Kettering: London Rd Church Walk		1032	1052	1112	1132	1152	1212	1232	1252
Kettering: Horse Market Dalkeith Place		1033	1053	1113	1133	1153	1213	1233	1253
Kettering: Newland St Stop 5		1035	1055	1115	1135	1155	1215	1235	1255
Kettering: Lower Street A6003		1036	1056	1116	1136	1156	1216	1236	1256
Kettering: Rothwell Rd o/s Hospital		1038	1058	1118	1138	1158	1218	1238	1258
Kettering: Rothwell Rd opp Telford Way		1039	1059	1119	1139	1159	1219	1239	1259
Kettering: Telford Way Baron Ave		--	--	--	--	--	--	--	--
Kettering: Telford Way opp Enterprise Cl		--	--	--	--	--	--	--	--
Kettering: Telford Way Linnell Way		--	--	--	--	--	--	--	--
Kettering: Henson Way opp Torridge Cl		--	--	--	--	--	--	--	--
Kettering: Henson Way opp Riley Rd		--	--	--	--	--	--	--	--
Rothwell: Kettering Rd opp Jubilee Street		1044	1104	1124	1144	1204	1224	1244	1304
Rothwell: Kettering Rd opp Gordon Street		1044	1104	1124	1144	1204	1224	1244	1304
Rothwell: Kettering Rd Fox Street		1045	1105	1125	1145	1205	1225	1245	1305
Rothwell: Desborough Rd by The Maltings		1045	1105	1125	1145	1205	1225	1245	1305
Rothwell: Desborough Rd Greening Rd		1046	1106	1126	1146	1206	1226	1246	1306
Desborough: Rothwell Rd Pioneer Ave		1048	1108	1128	1148	1208	1228	1248	1308
Desborough: High St o/s Library		--	1110	1130	--	1210	1230	--	1310
Desborough: Harborough Rd Ironwood Avenue Arr:		--	1113	--	--	1213	--	--	1313
Desborough: Dunkirk Ave opp Breakleys Rd		1053	--	--	1153	--	--	1253	--
Desborough: Braybrooke Rd opp Hilltop Arr:		--	--	1133	--	--	1233	--	--

Key: Firm times shown as: 1200 Estimated times shown as: 1200

Notes		SUC	SUC	SUC	SUC	SUC	SUC	SUC	SUC
Operators	Service Number	19	19	19	19	19	19	19	19
Kettering: Library Stop 11 Dep:		1310	1330	1350	1410	1430	1450	1510	1530
Kettering: London Rd Church Walk		1312	1332	1352	1412	1432	1452	1512	1532
Kettering: Horse Market Dalkeith Place		1313	1333	1353	1413	1433	1453	1513	1533
Kettering: Newland St Stop 5		1315	1335	1355	1415	1435	1455	1515	1535
Kettering: Lower Street A6003		1316	1336	1356	1416	1436	1456	1516	1536
Kettering: Rothwell Rd o/s Hospital		1318	1338	1358	1418	1438	1458	1518	1538

Kettering: Rothwell Rd opp Telford Way	1319	1339	1359	1419	1439	1459	1519	1539
Kettering: Telford Way Baron Ave	--	--	--	--	--	--	--	--
Kettering: Telford Way opp Enterprise Cl	--	--	--	--	--	--	--	--
Kettering: Telford Way Linnell Way	--	--	--	--	--	--	--	--
Kettering: Henson Way opp Torridge Cl	--	--	--	--	--	--	--	--
Kettering: Henson Way opp Riley Rd	--	--	--	--	--	--	--	--
Rothwell: Kettering Rd opp Jubilee Street	1324	1344	1404	1424	1444	1504	1524	1544
Rothwell: Kettering Rd opp Gordon Street	1324	1344	1404	1424	1444	1504	1524	1544
Rothwell: Kettering Rd Fox Street	1325	1345	1405	1425	1445	1505	1525	1545
Rothwell: Desborough Rd by The Mallings	1325	1345	1405	1425	1445	1505	1525	1545
Rothwell: Desborough Rd Greening Rd	1326	1346	1406	1426	1446	1506	1526	1546
Desborough: Rothwell Rd Pioneer Ave	1328	1348	1408	1428	1448	1508	1528	1548
Desborough: High St o/s Library	1330	--	1410	1430	--	1510	1530	--
Desborough: Harborough Rd Ironwood Avenue Arr:	--	--	1413	--	--	1513	--	--
Desborough: Dunkirk Ave opp Breakleys Rd	--	1353	--	--	1453	--	--	1553
Desborough: Braybrooke Rd opp Hilltop Arr:	1333	--	--	1433	--	--	1533	--

Key: Firm times shown as: 1200 Estimated times shown as: 1200

Notes									
Operators	SUC	SUC	SUC	SUC	SUC	SUC	SUC	SUC	SUC
Service Number	19	19	19	19	19	19	19	19	19
Kettering: Library Stop 11 Dep:	1550	1610	1630	1655	1715	1735	1755	1815	
Kettering: London Rd Church Walk	1552	1612	1632	1657	1717	1737	1757	1817	
Kettering: Horse Market Dalkeith Place	1553	1613	1633	1658	1718	1738	1758	1818	
Kettering: Newland St Stop 5	1555	1615	1635	1700	1720	1740	1800	1820	
Kettering: Lower Street A6003	1556	1616	1636	1701	1721	1741	1801	1821	
Kettering: Rothwell Rd o/s Hospital	1558	1618	1638	1703	1723	1743	1803	1823	
Kettering: Rothwell Rd opp Telford Way	1559	1619	1639	1704	1724	1744	1804	1824	
Kettering: Telford Way Baron Ave	--	--	--	--	--	--	--	--	
Kettering: Telford Way opp Enterprise Cl	--	--	--	--	--	--	--	--	
Kettering: Telford Way Linnell Way	--	--	--	--	--	--	--	--	
Kettering: Henson Way opp Torridge Cl	--	--	--	--	--	--	--	--	
Kettering: Henson Way opp Riley Rd	--	--	--	--	--	--	--	--	
Rothwell: Kettering Rd opp Jubilee Street	1604	1624	1644	1709	1729	1749	1809	1829	
Rothwell: Kettering Rd opp Gordon Street	1604	1624	1644	1709	1729	1749	1809	1829	
Rothwell: Kettering Rd Fox Street	1605	1625	1645	1710	1730	1750	1810	1830	
Rothwell: Desborough Rd by The Mallings	1605	1625	1645	1710	1730	1750	1810	1830	
Rothwell: Desborough Rd Greening Rd	1606	1626	1646	1711	1731	1751	1811	1831	
Desborough: Rothwell Rd Pioneer Ave	1608	1628	1648	1713	1733	1753	1813	1833	
Desborough: High St o/s Library	1610	1630	--	1715	1735	--	1815	1835	
Desborough: Harborough Rd Ironwood Avenue Arr:	1613	--	--	1718	--	--	1818	--	
Desborough: Dunkirk Ave opp Breakleys Rd	--	--	1653	--	--	1758	--	--	
Desborough: Braybrooke Rd opp Hilltop Arr:	--	1633	--	--	1738	--	--	1838	

Key: Firm times shown as: 1200 Estimated times shown as: 1200

Notes					
Operators	SUC	SUC	SUC	SUC	SUC
Service Number	19	19	19	19	19
Kettering: Library Stop 11 Dep:	1835	1935	2035	2135	2305
Kettering: London Rd Church Walk	1837	1937	2037	2137	2307
Kettering: Horse Market Dalkeith Place	1838	1938	2038	2138	2308
Kettering: Newland St Stop 5	1840	1940	2040	2140	2310
Kettering: Lower Street A6003	1841	1941	2041	2141	2311
Kettering: Rothwell Rd o/s Hospital	1843	1943	2043	2143	2313
Kettering: Rothwell Rd opp Telford Way	1844	1944	2044	2144	2314
Kettering: Telford Way Baron Ave	--	--	--	--	--
Kettering: Telford Way opp Enterprise Cl	--	--	--	--	--
Kettering: Telford Way Linnell Way	--	--	--	--	--
Kettering: Henson Way opp Torridge Cl	--	--	--	--	--
Kettering: Henson Way opp Riley Rd	--	--	--	--	--
Rothwell: Kettering Rd opp Jubilee Street	1849	1949	2049	2149	2319
Rothwell: Kettering Rd opp Gordon Street	1849	1949	2049	2149	2319
Rothwell: Kettering Rd Fox Street	1850	1950	2050	2150	2320
Rothwell: Desborough Rd by The Mallings	1850	1950	2050	2150	2320
Rothwell: Desborough Rd Greening Rd	1851	1951	2051	2151	2321
Desborough: Rothwell Rd Pioneer Ave	1853	1953	2053	2153	2323
Desborough: High St o/s Library	--	--	--	--	--
Desborough: Harborough Rd Ironwood Avenue Arr:	--	--	--	--	--
Desborough: Dunkirk Ave opp Breakleys Rd	1858	1958	2058	2158	2328
Desborough: Braybrooke Rd opp Hilltop Arr:	--	--	--	2203	2333

Key: Firm times shown as: 1200 Estimated times shown as: 1200

Notes:

SUC = Stagecoach

Results compiled from a timetable database built on 08/11/2008 07:00:08



Help

Route Timetables

[Change Request](#) [Print](#)

Date: Sunday 16 November

19 Desborough - Rothwell - Kettering

	Notes						
Operators	SUC	SUC	SUC	SUC	SUC	SUC	SUC
Service Number	19	19	19	19	19	19	19
Desborough: Braybrooke Rd opp Hilltop Dep:	1105	1305	1505	1705	1905	2105	
Desborough: Braybrooke Rd Sports Ground	1105	1305	1505	1705	1905	2105	
Desborough: Gold Street opp Harrington Rd	1106	1306	1506	1706	1906	2106	
Desborough: High St Chip Shop	1107	1307	1507	1707	1907	2107	
Desborough: Dunkirk Ave Paddock La	1108	1308	1508	1708	1908	2108	
Desborough: Dunkirk Ave opp Breakleys Rd	1108	1308	1508	1708	1908	2108	
Desborough: Ise Vale Ave Dunkirk Ave	1108	1308	1508	1708	1908	2108	
Desborough: Ise Vale Ave Broadlands	1108	1308	1508	1708	1908	2108	
Desborough: Broadlands Chestnut Drive	1109	1309	1509	1709	1909	2109	
Desborough: Broadlands opp Redwood Cl	1109	1309	1509	1709	1909	2109	
Desborough: Rushton Rd opp the Cemetery	1109	1309	1509	1709	1909	2109	
Desborough: Rushton Rd Mayfield Rd	1109	1309	1509	1709	1909	2109	
Desborough: Rushton Rd Union St	1110	1310	1510	1710	1910	2110	
Desborough: Station Rd Queen St	1110	1310	1510	1710	1910	2110	
Desborough: High St Chip Shop	1111	1311	1511	1711	1911	2111	
Desborough: Lower St Church	1112	1312	1512	1712	1912	2112	
Desborough: St Anthony's Hill opp Federation Av	1113	1313	1513	1713	1913	2113	
Desborough: Rothwell Rd opp Pioneer Ave	1113	1313	1513	1713	1913	2113	
Rothwell: Desborough Rd opp Greening Rd	1117	1317	1517	1717	1917	2117	
Rothwell: High Street War Memorial	1118	1318	1518	1718	1918	2118	
Rothwell: Kettering Rd Gordon Street	1119	1319	1519	1719	1919	2119	
Rothwell: Kettering Rd Jubilee Street	1119	1319	1519	1719	1919	2119	
opp The Woodlands Hospital A14	1121	1321	1521	1721	1921	2121	
Kettering: Rothwell Rd Telford Way	1122	1322	1522	1722	1922	2122	
Kettering: Rothwell Rd opp Hospital	1123	1323	1523	1723	1923	2123	
Kettering: Eskdail St Stop 6	1130	1330	1530	1730	1930	2130	
Kettering: Victoria St opp School La	1131	1331	1531	1731	1931	2131	
Kettering: Library Stop 11 Arr:	1133	1333	1533	1733	1933	2133	

Key: Firm times shown as: 1200 Estimated times shown as: 1200

Notes:

SUC = Stagecoach

[Change Request](#) [Print](#)

Results compiled from a timetable database built on 08/11/2008 07:00:08



Help

Route Timetables

[Change Request](#) [Print](#)

Date: Sunday 16 November

19 Kettering - Rothwell - Desborough

	Notes						
Operators	SUC	SUC	SUC	SUC	SUC	SUC	SUC
Service Number	19	19	19	19	19	19	19
Kettering: Library Stop 11 Dep:	1035	1235	1435	1635	1835	2035	
Kettering: London Rd Church Walk	1037	1237	1437	1637	1837	2037	
Kettering: Horse Market Dalkeith Place	1038	1238	1438	1638	1838	2038	
Kettering: Newland St Stop 5	1040	1240	1440	1640	1840	2040	
Kettering: Lower Street A6003	1041	1241	1441	1641	1841	2041	
Kettering: Rothwell Rd o/s Hospital	1043	1243	1443	1643	1843	2043	
Kettering: Rothwell Rd opp Telford Way	1044	1244	1444	1644	1844	2044	
Rothwell: Kettering Rd opp Jubilee Street	1049	1249	1449	1649	1849	2049	
Rothwell: Kettering Rd opp Gordon Street	1049	1249	1449	1649	1849	2049	
Rothwell: Kettering Rd Fox Street	1050	1250	1450	1650	1850	2050	
Rothwell: Desborough Rd by The Maltings	1050	1250	1450	1650	1850	2050	
Rothwell: Desborough Rd Greening Rd	1051	1251	1451	1651	1851	2051	
Desborough: Rothwell Rd Pioneer Ave	1053	1253	1453	1653	1853	2053	
Desborough: High St Chip Shop	1055	1255	1455	1655	1855	2055	
Desborough: Dunkirk Ave Paddock La	1056	1256	1456	1656	1856	2056	
Desborough: Dunkirk Ave opp Breakleys Rd	1058	1258	1458	1658	1858	2058	
Desborough: Ise Vale Ave Dunkirk Ave	1058	1258	1458	1658	1858	2058	
Desborough: Ise Vale Ave Broadlands	1059	1259	1459	1659	1859	2059	
Desborough: Broadlands Chestnut Drive	1059	1259	1459	1659	1859	2059	
Desborough: Broadlands opp Redwood Cl	1059	1259	1459	1659	1859	2059	
Desborough: Rushton Rd opp the Cemetery	1100	1300	1500	1700	1900	2100	
Desborough: Rushton Rd Mayfield Rd	1100	1300	1500	1700	1900	2100	
Desborough: Rushton Rd Union St	1101	1301	1501	1701	1901	2101	
Desborough: Station Rd Queen St	1101	1301	1501	1701	1901	2101	
Desborough: Gold St Harrington Rd	1102	1302	1502	1702	1902	2102	
Desborough: Braybrooke Rd opp Hilltop Arr:	1103	1303	1503	1703	1903	2103	

Key: Firm times shown as: 1200 Estimated times shown as: 1200

Notes:

SUC = Stagecoach

[Change Request](#) [Print](#)

Results compiled from a timetable database built on 08/11/2008 07:00:08

APPENDIX C



Help

Route Timetables

[Change Request](#) [Print](#)

Date: Monday 10 November to Friday 14 November

304 Desborough - Rothwell - Northampton

	Notes	We
	Operators	HBC
	Service Number	304
Desborough: High St Chip Shop Dep:		0953
Desborough: Lower St Church		0954
Desborough: St Anthony's Hill opp Federation Av		0955
Desborough: Rothwell Rd opp Pioneer Ave		0956
Rothwell: Desborough Rd opp Greening Rd		0957
Rothwell: Bridge Street opp Market Hill		1000
Rothwell: Market Hill Market House		1001
Rothwell: High Street War Memorial		1003
Rothwell: Kettering Rd Gordon Street		1004
Rothwell: Kettering Rd Jubilee Street		1004
Loddington: Harrington Rd Cransley Turn		1008
Cransley: Loddington Rd opp Village Hall		1010
Cransley: Broughton Hill opp Three Cranes		1010
Broughton: Cransley Rd West St		1013
Broughton: High St o/s Red Lion PH		1015
Broughton: Northampton Rd Wellingborough Rd		1016
Broughton: Northampton Rd Donaldson Ave		1017
Moulton: A43 Overstone Turn		1022
Moulton: Kettering Rd The Avenue		1023
Thorpeville: Thorpeville Rd o/s No10		1024
Thorpeville: Thorpeville Rd Stone Circle Rd		1027
Thorpeville: Booth Rise o/s No58		1028
Thorpeville: Booth Rise Lumbertubs La		1028
Boothville: Kettering Rd o/s Lumbertubs PH		1029
Spinney Hill: Kettering Rd opp Thomas Becket Sch		1029
Spinney Hill: Kettering Rd opp Spinney Hill Rd		1030
Spinney Hill: Kettering Rd o/s Spinney Hill PH		1032
Spinney Hill: Kettering Rd opp Morrisons		1033
Kingsley Park: Kettering Rd Tudor Rd		1034
Kingsley Park: Kettering Rd Brookland Rd		1035
Kingsley Park: Kettering Rd o/s St Matthews Ch		1036
Kingsley Park: Kettering Rd opp White Elephant P		1037
Kingsley Park: Kettering Rd opp Hood St		1038
Kingsley Park: Kettering Rd opp John Clare Centr		1039
Kingsley Park: Kettering Rd opp Grove Rd		1040
Northampton: Abington Square Stop A3		1041
Northampton: Lower Mounts Stop A5		1041
Northampton: Greyfriars Bus Station Bus Station Arr:		1042

Key: Firm times shown as: 1200 Estimated times shown as: 1200

Notes:

HBC = Hamiltons & Buckbys
 We = Wednesday Only

[Change Request](#) [Print](#)

Results compiled from a timetable database built on 08/11/2008 07:00:08



Help

Route Timetables

[Change Request](#) [Print](#)

Date: Monday 10 November to Friday 14 November

304 Northampton - Rothwell - Desborough

	Notes	We
	Operators	HBC
	Service Number	304
Northampton: Greyfriars Bus Station Bay 7 Dep:		1400
Northampton: Abington Square Stop A2		1401
Kingsley Park: Kettering Rd o/s Methodist Church		1402
Kingsley Park: Kettering Rd o/s Baptist Church		1403
Kingsley Park: Kettering Rd Racecourse		1404
Kingsley Park: Kettering Rd o/s Post Office		1405
Kingsley Park: Kettering Rd o/s Co-op		1406
Kingsley Park: Kettering Rd Raeburn Rd		1407
Kingsley Park: Kettering Rd Kenmuir Ave		1408
Spinney Hill: Kettering Rd o/s Morrisons		1409
Spinney Hill: Kettering Rd Highlands Ave		1410
Spinney Hill: Kettering Rd Spinney Hill Rd		1412
Spinney Hill: Kettering Rd o/s Thomas Becket Sch		1412
Boothville: Booth Rise opp Lumbertubs PH		1413
Thorpeville: Booth Rise o/s No55		1414
Thorpeville: Thorpeville Rd opp Round Spinney		1415
Thorpeville: Thorpeville Rd opp No18		1416
Moulton: Kettering Rd Ashley Lane		1418
Moulton: A43 Park View opp Overstone Turn		1419
Broughton: Northampton Rd opp Donaldson Ave		1426
Broughton: High St opp Red Lion PH		1427
Broughton: Cransley Hill opp West Street		1428
Cransley: Loddington Rd o/s Three Cranes		1432
Cransley: Loddington Rd o/s Village Hall		1432
Loddington: Harrington Rd opp Cransley Turn		1434
Rothwell: Kettering Rd opp Jubilee Street		1441
Rothwell: Kettering Rd opp Gordon Street		1441
Rothwell: Kettering Rd Fox Street		1441
Rothwell: Bridge Street opp Market Hill		1442
Rothwell: Market Hill Market House		1442
Rothwell: Desborough Rd by The Maltings		1443
Rothwell: Desborough Rd Greening Rd		1444
Desborough: Rothwell Rd Pioneer Ave		1448
Desborough: High St o/s Library Arr:		1449

Key: Firm times shown as: 1200 Estimated times shown as: 1200

Notes:

HBC = Hamiltons & Buckbys
We = Wednesday Only

[Change Request](#) [Print](#)

Results compiled from a timetable database built on 08/11/2008 07:00:08

Signed as a deed by **JACQUELINE**)
MARGARET THAME in the presence of:)

Signature J m Thame

Witness signature J. Norman

Witness name (block capitals) J. NORMAN

Witness address 16 MALINGS WAY
ST. BARNETS WAY
BEOS.

Signed as a deed by **JOHN GRAHAM**)
REAMS in the presence of:)

Signature J G Reams

Witness signature S. Hartas

Witness name (block capitals) S. HARTAS

Witness address 528 GOLDINGTON RD
BEDFORD
MK41 0DX